

TETRAS

280



Release 1.0

Always check on www.msheli.com for a more recent version of this manual

Diagonal (motor to motor)..... 280mm

Motor available size..... up to 22xx

Propeller available size.... 5"- 6"

Overall height.... 100mm (including Canopy)

Battery compartment size.... 110 x 40 (up to 4s 2200mah)

Tools required for assembly



Hexagon screw drivers : 1,5mm

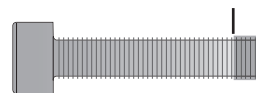

Where indicated use Thread lock MEDIUM



Safety notes

Operate the model in open areas with no people nearby.

Do NOT operate the model in the following places and situations (or else you risk severe accidents):

- in places where children gather or people pass through
- in residential areas and parks
- indoors and in limited space
- in windy weather or when there is rain, snow, fog or other precipitation

If you do not observe these instructions you may be held liable for personal injury or property damage!

Always check the R/C system prior to operating your model.

When the R/C system batteries get weaker, the operational range of the R/C system decreases.

Note that you may lose control of your model when operating it under such conditions.

Keep in mind that other people around you might also be operating a R/C model.

Never use a frequency which someone else is using at the same time.

Radio signals will be mixed and you will lose control of your model.

If the model shows irregular behavior, bring the model to a halt immediately and disconnect the batteries.

Investigate the reason and fix the problem.

Do not operate the model again as long as the problem is not solved, as this may lead to further trouble and unforeseen accidents.

In order to prevent accidents and personal injury, be sure to observe the following:

Before flying the model, ensure that all screws are tightened.

A single loose screw may cause a major accident.

Replace all broken or defective parts with new ones, as damaged parts lead to crashes.

Never approach a spinning propeller. Keep at least 10 meters/yards away from a spinning propeller.

Do not touch the motor immediately after use. It may be hot enough to cause burns.

Perform all necessary maintenance.

PRIOR TO ADJUSTING AND OPERATING YOUR MODEL, OBSERVE THE FOLLOWING

Operate the model only outdoors and out of people's reach as the main rotor operates at high rpm!

While adjusting, stand at least 10 meters

Novice R/C pilots should always seek advice from experienced pilots to obtain hints with assembly and for pre-flight adjustments.

Note that a badly assembled or insufficiently adjusted of model is a safety hazard!

In the beginning, novice R/C pilots should always be assisted by an experienced pilot and never fly alone!

Camera pads

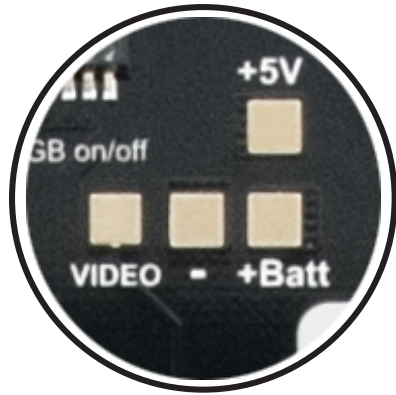

Flight controller connections

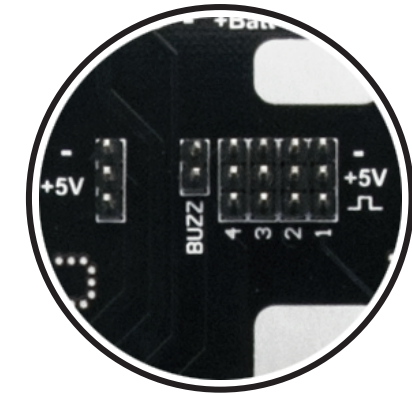

Video TX pads

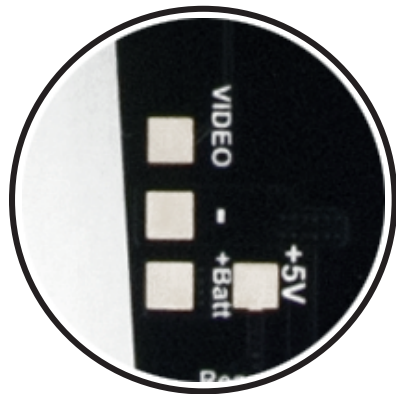

Integrated Buzzer module

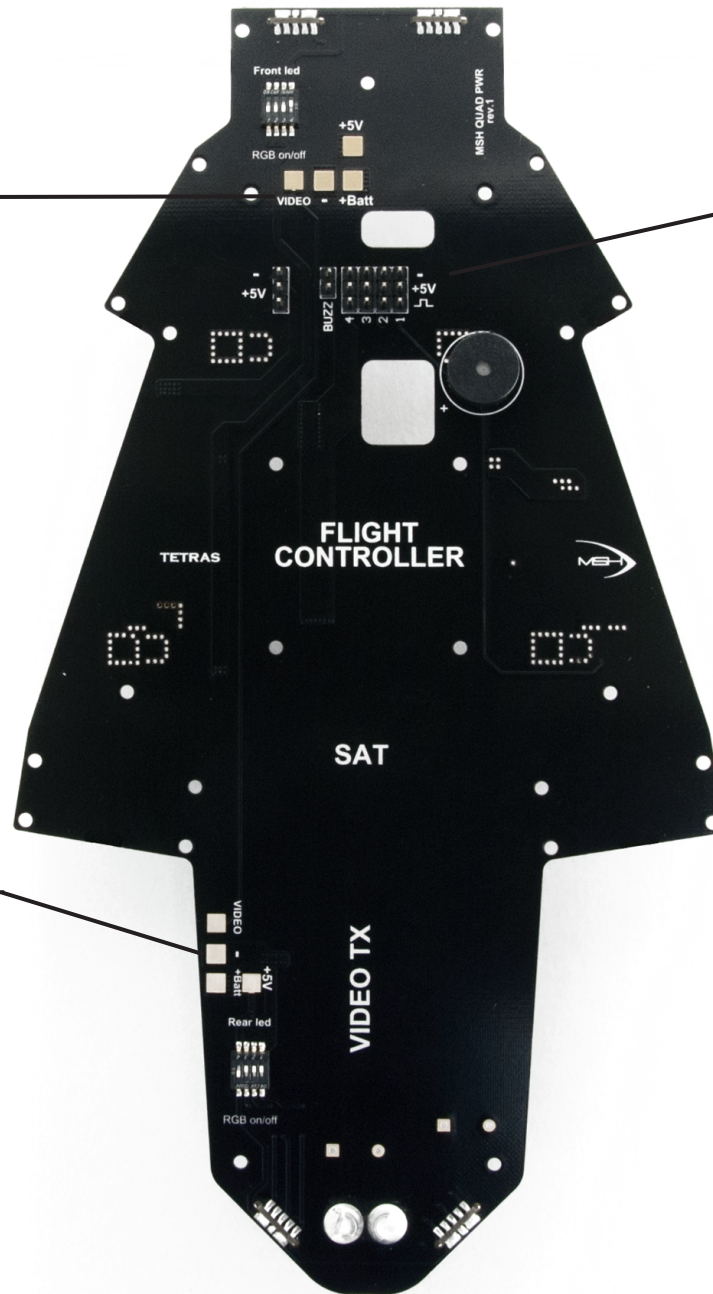
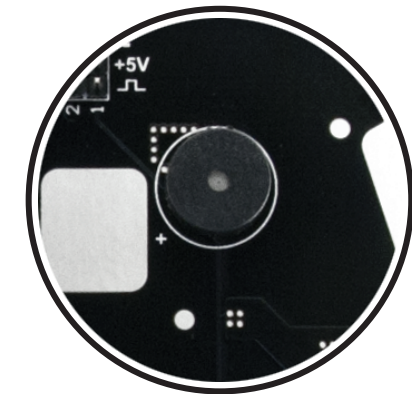

LC filters

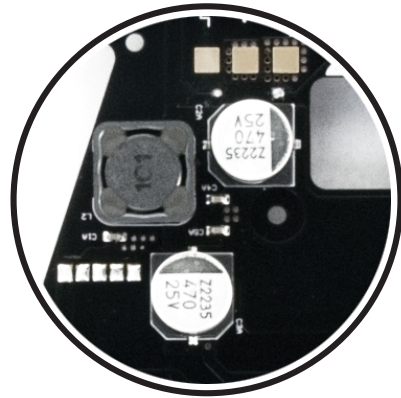

Integrated
5V BEC



ESC pads

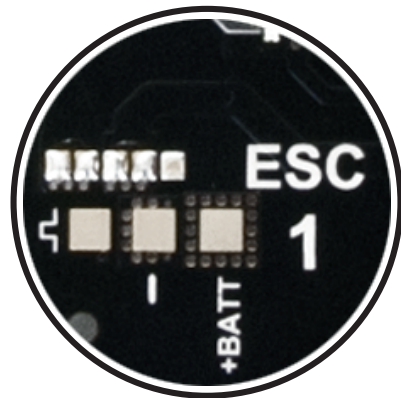

Leds

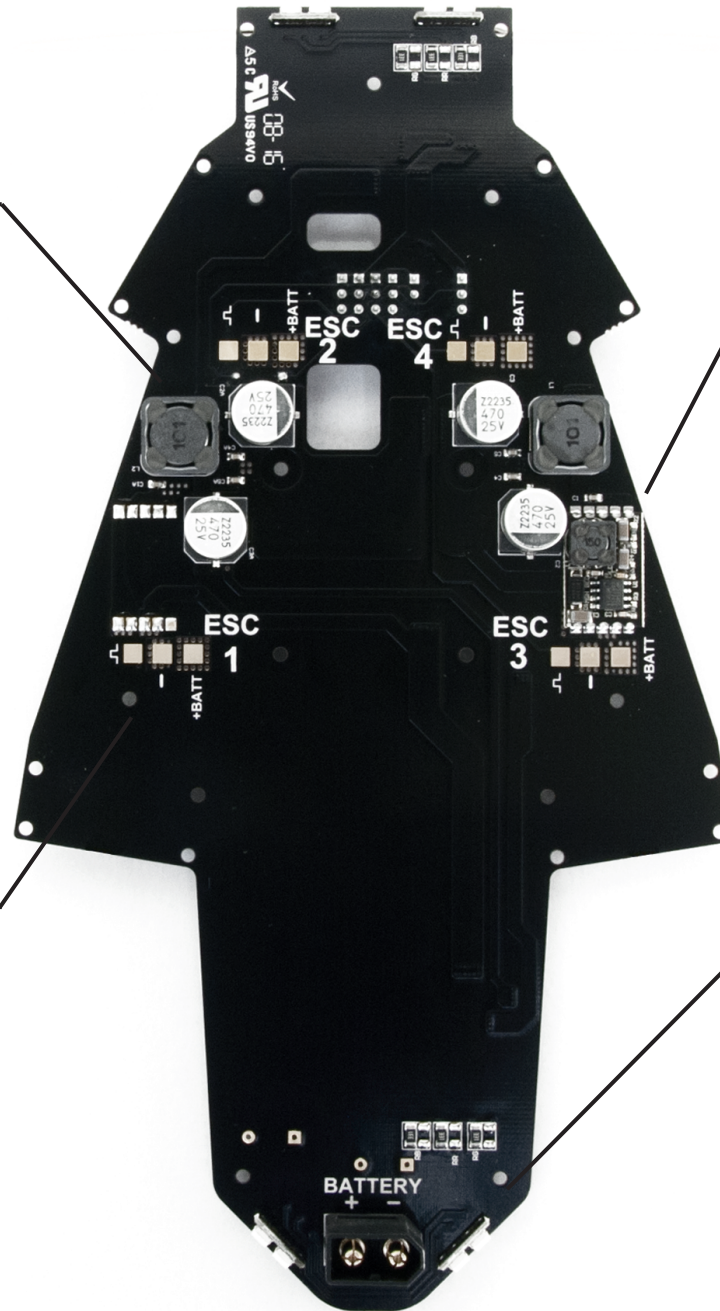
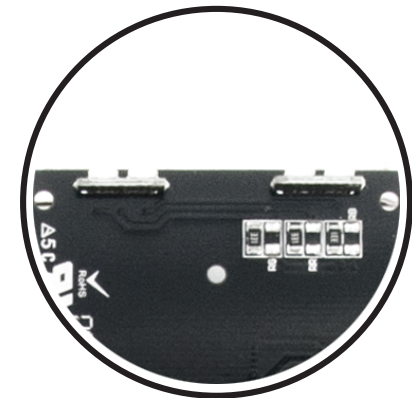

4X

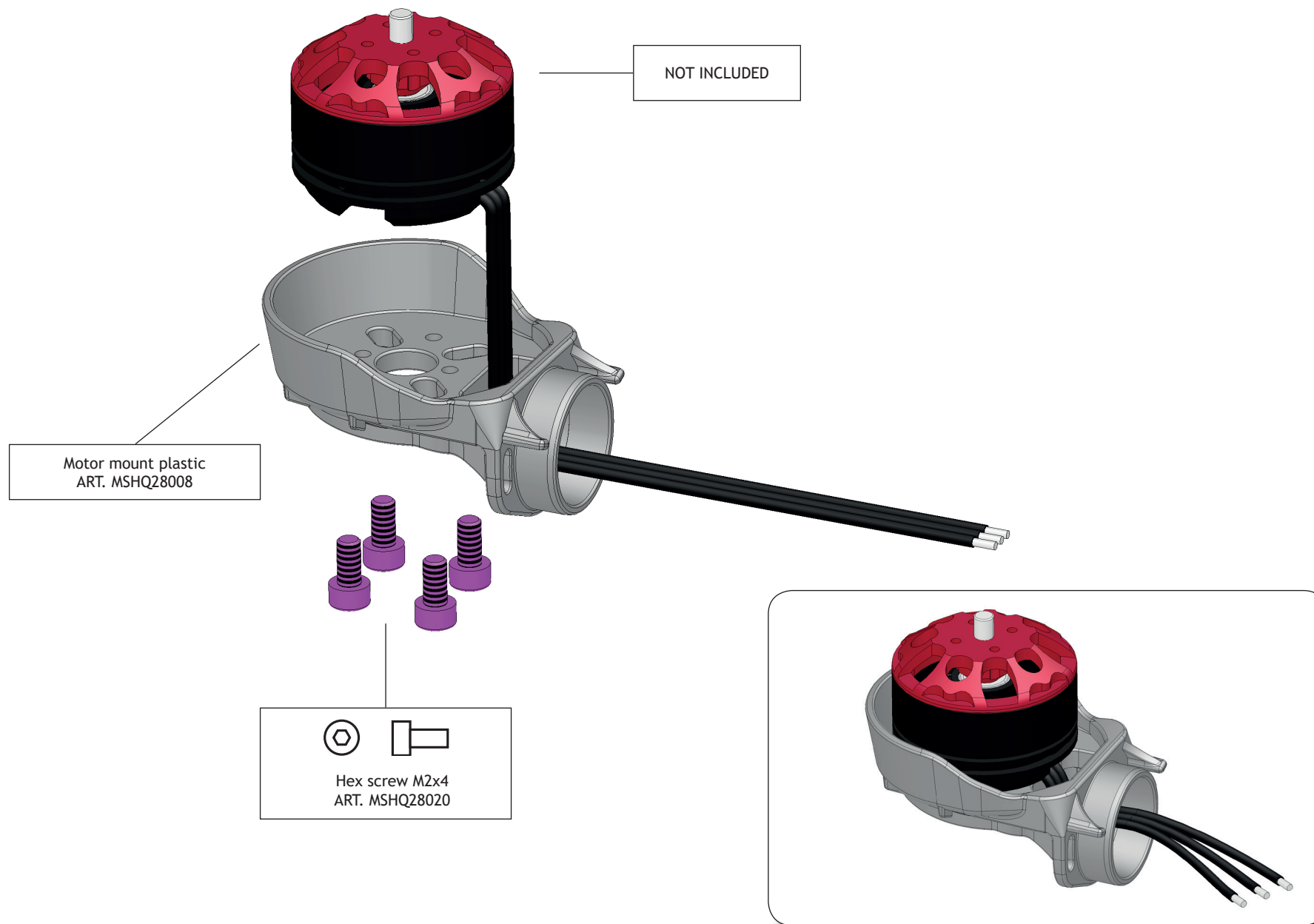

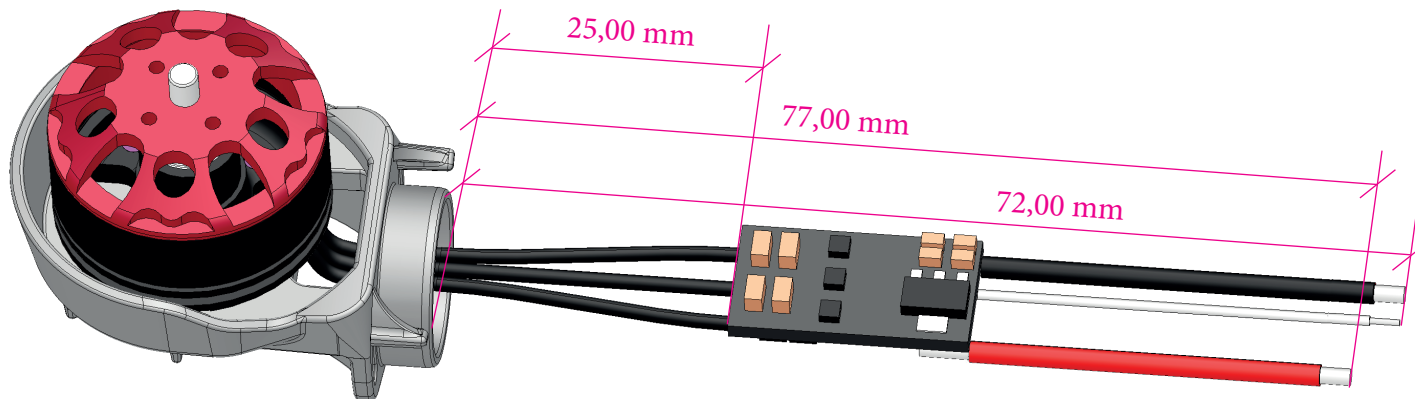

ESC 4

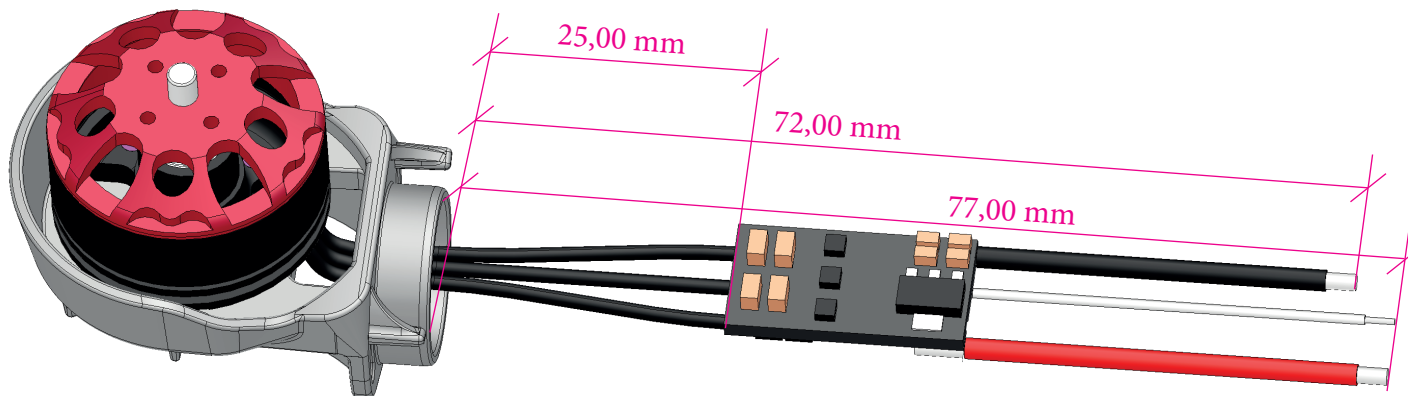

ESC 2

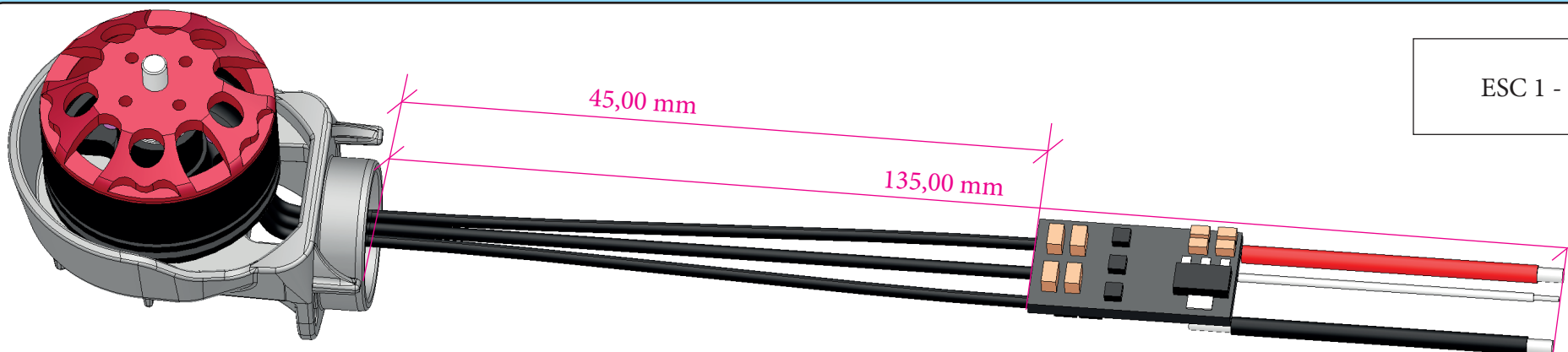

ESC 1 - ESC 3

ESC 4

ESC 2

Front arm
ART. MSHQ28009

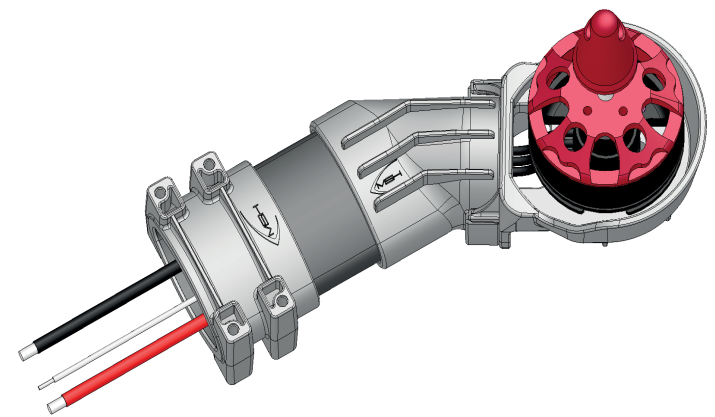
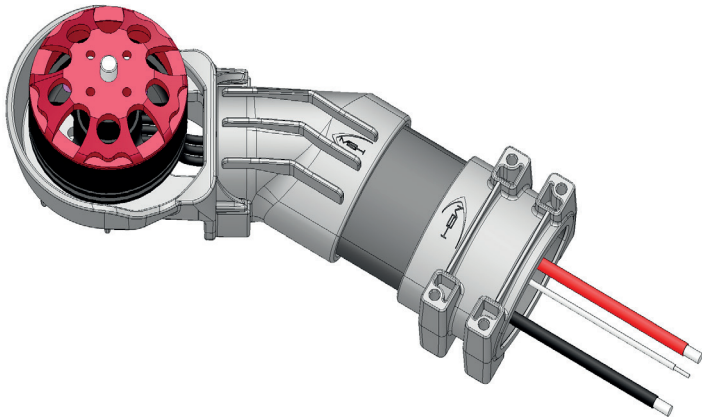
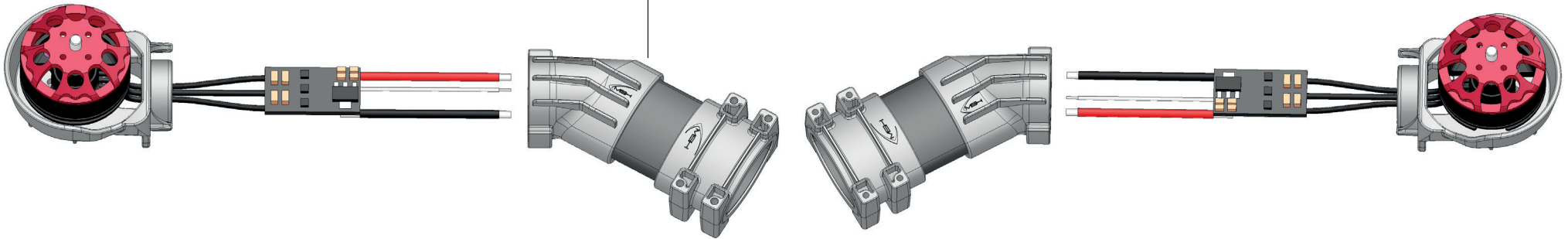

ESC 4

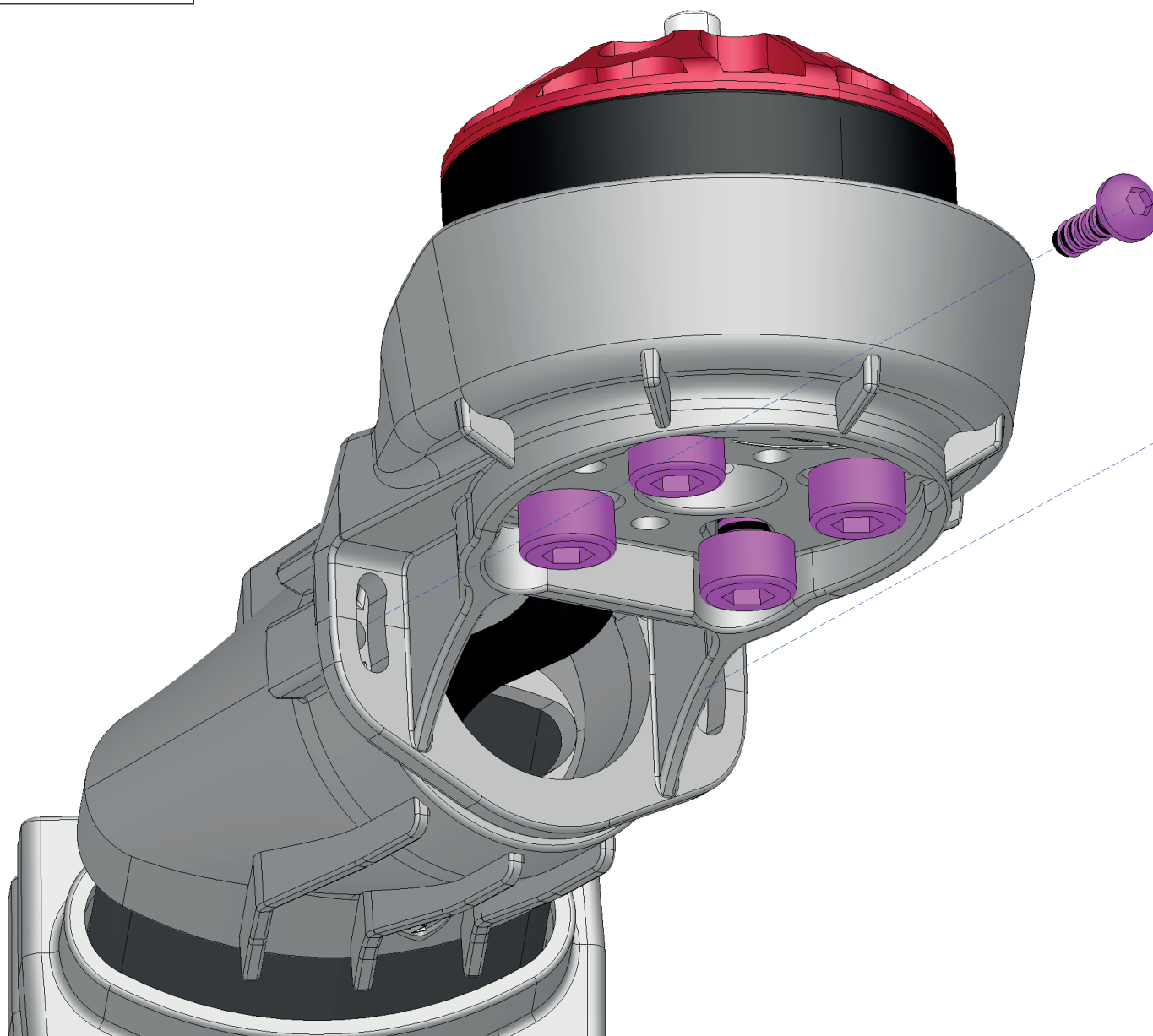

⊙ ⊢
M2x6 Self tapping screw
ART. MSHQ28021
ART. MSHQ28008

Do not fully thighten yet

ESC 2

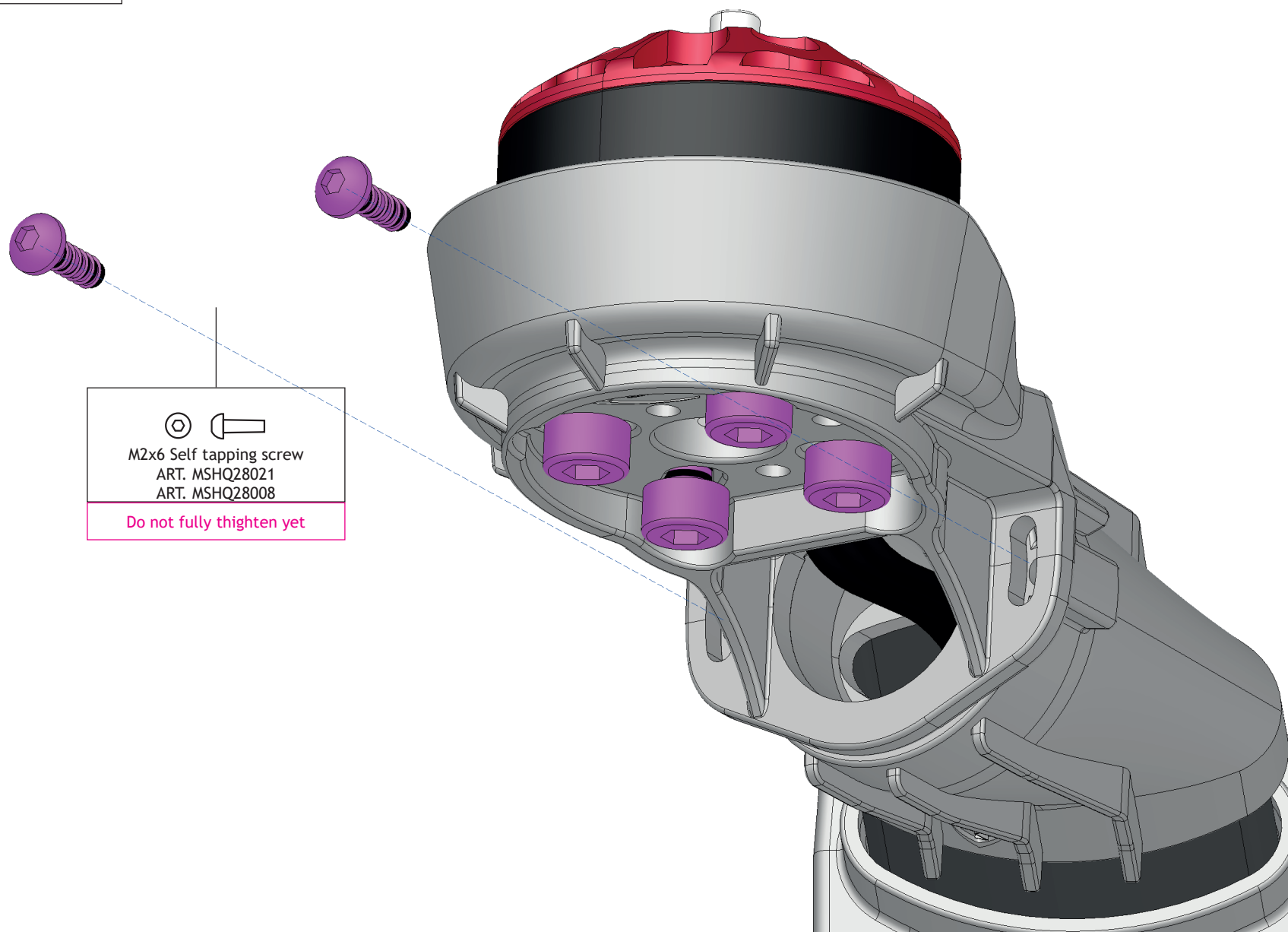

ESC 1

Rear arm
ART. MSHQ28010

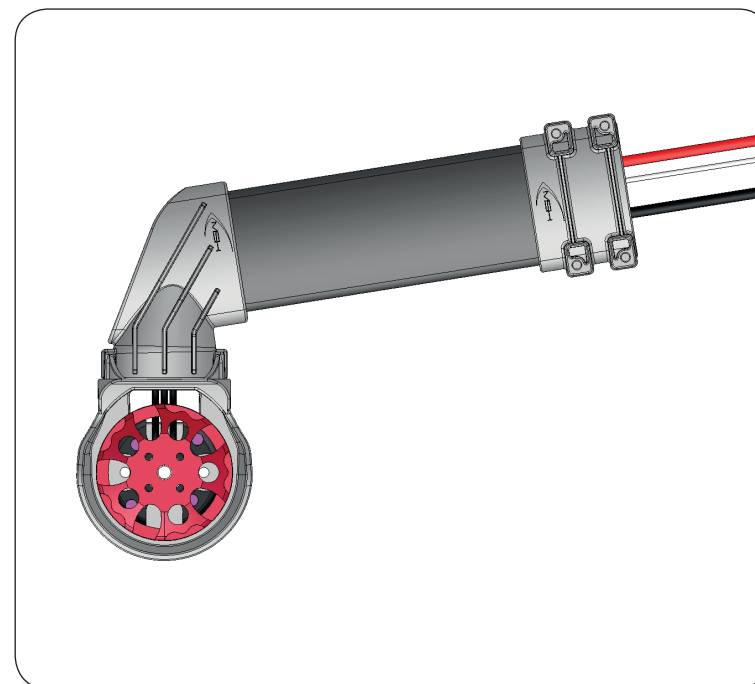
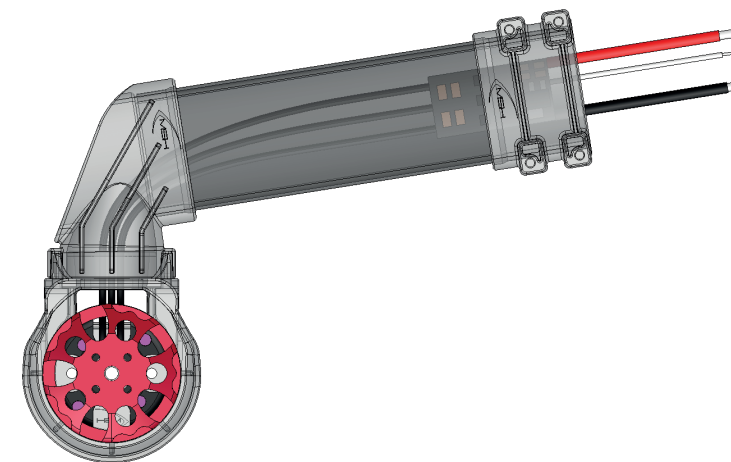
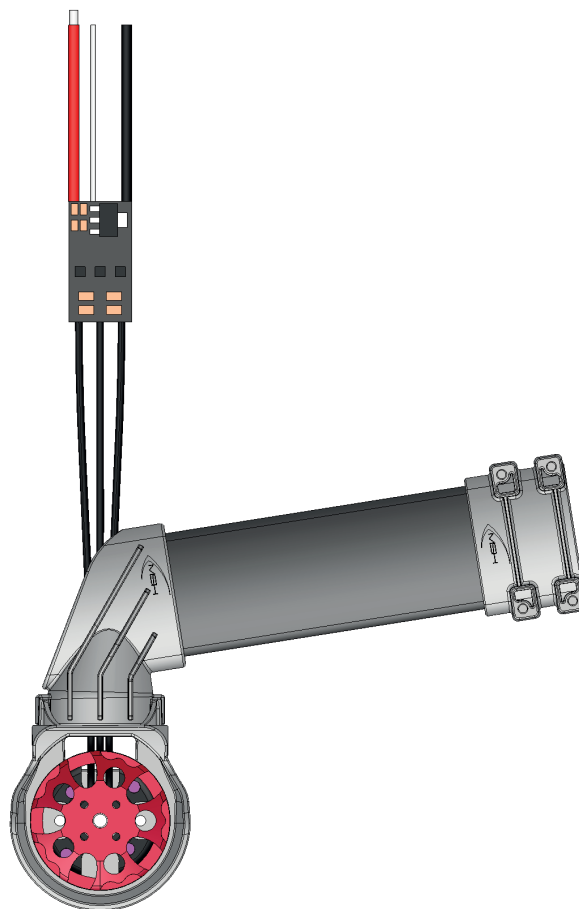
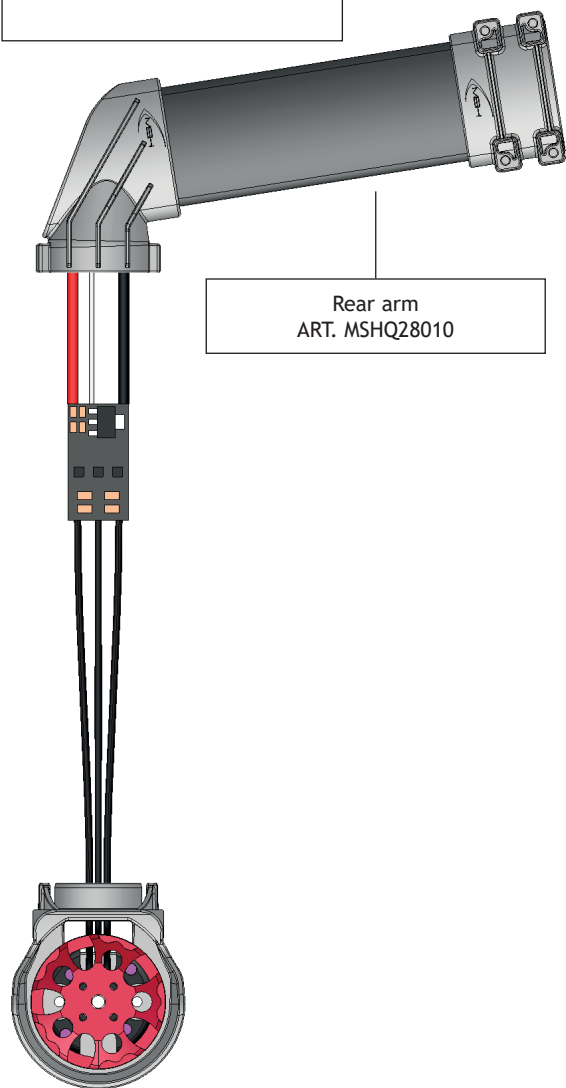

ESC 3

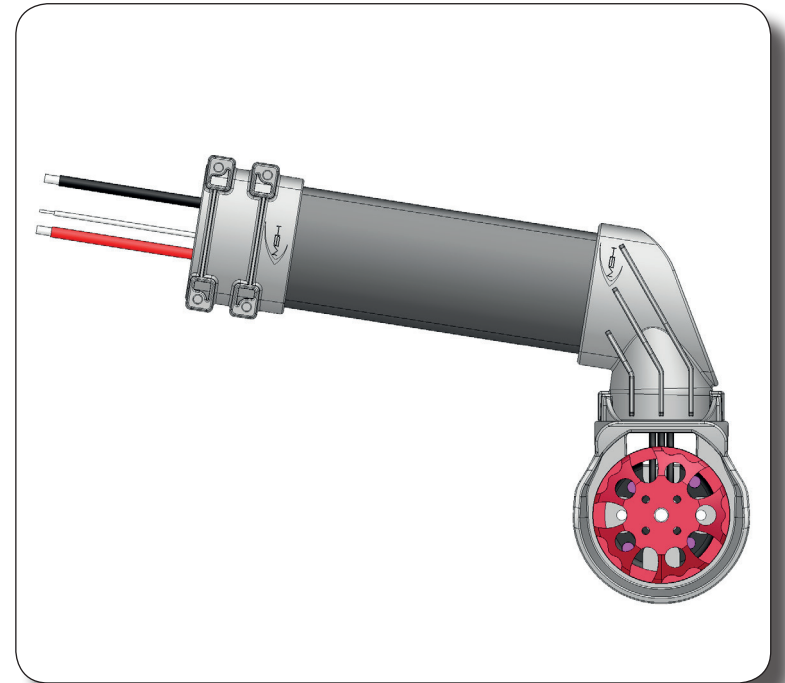
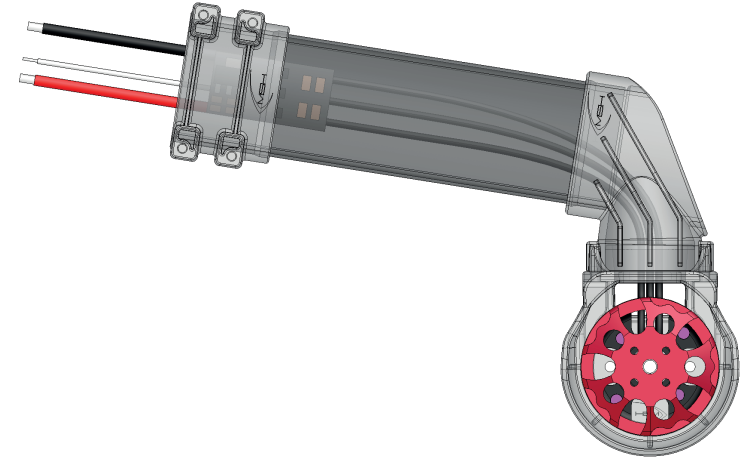
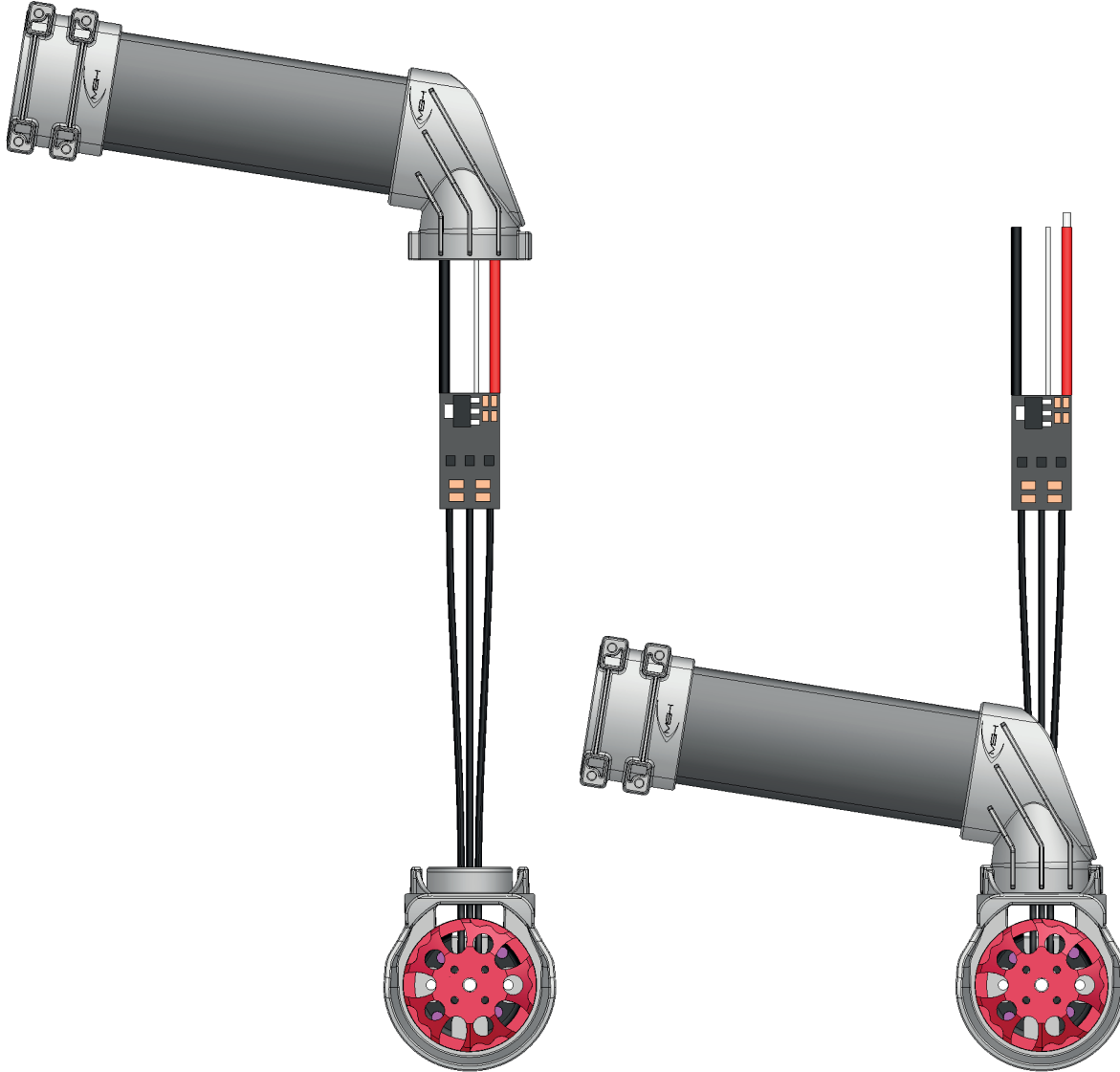

ESC 3

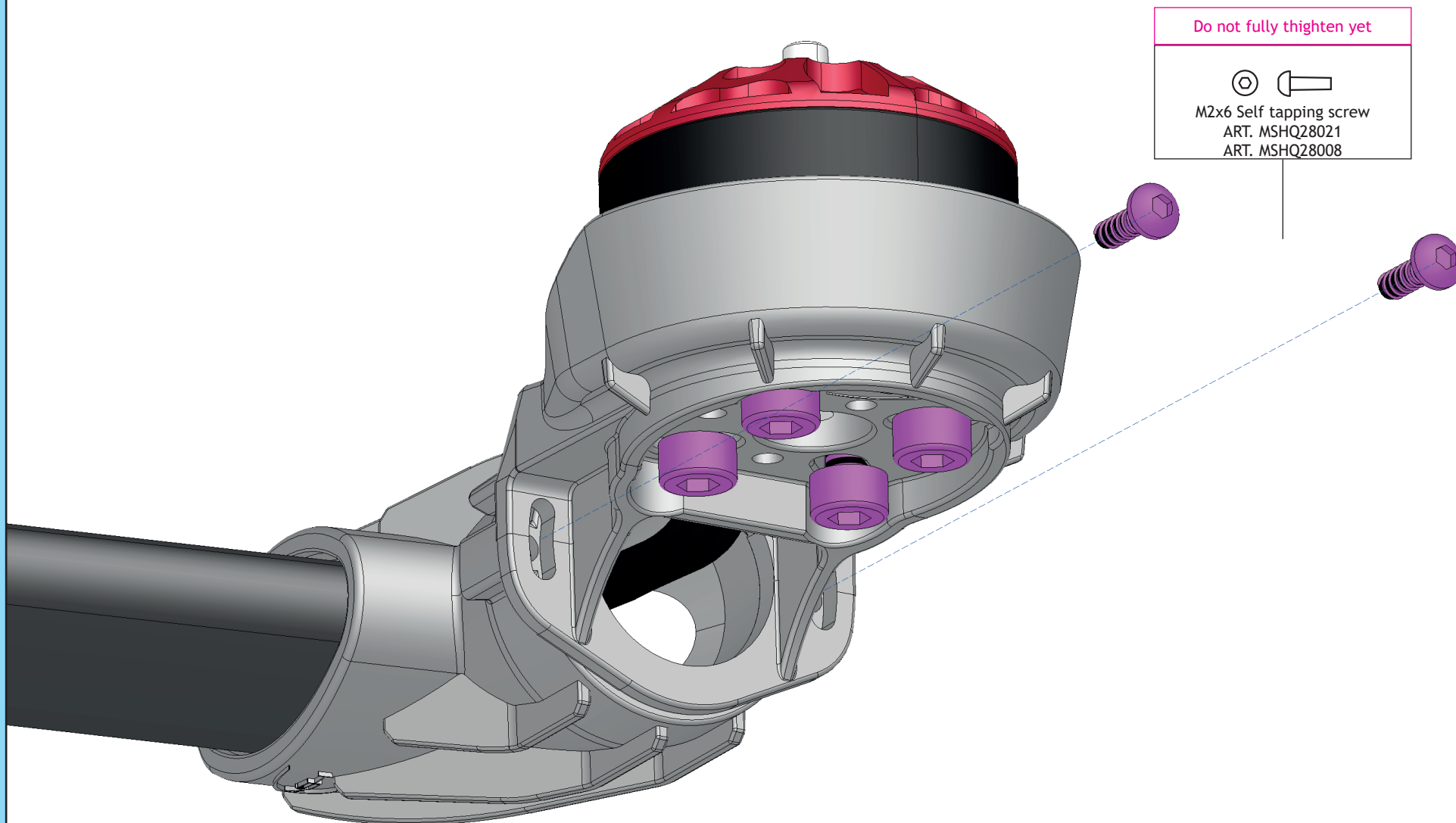

ESC 1

Do not fully thighten yet



M2x6 Self tapping screw
ART. MSHQ28021
ART. MSHQ28008

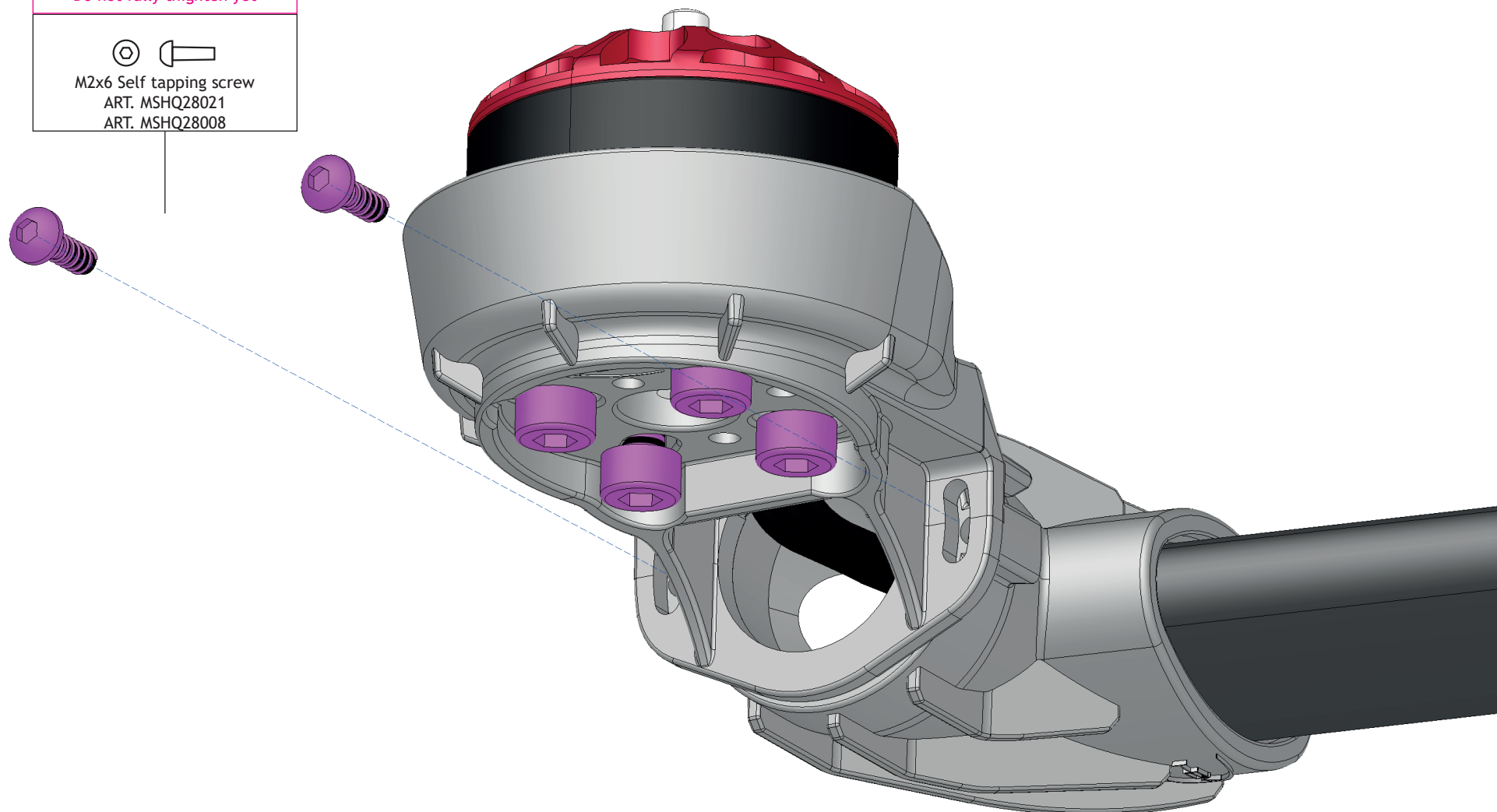

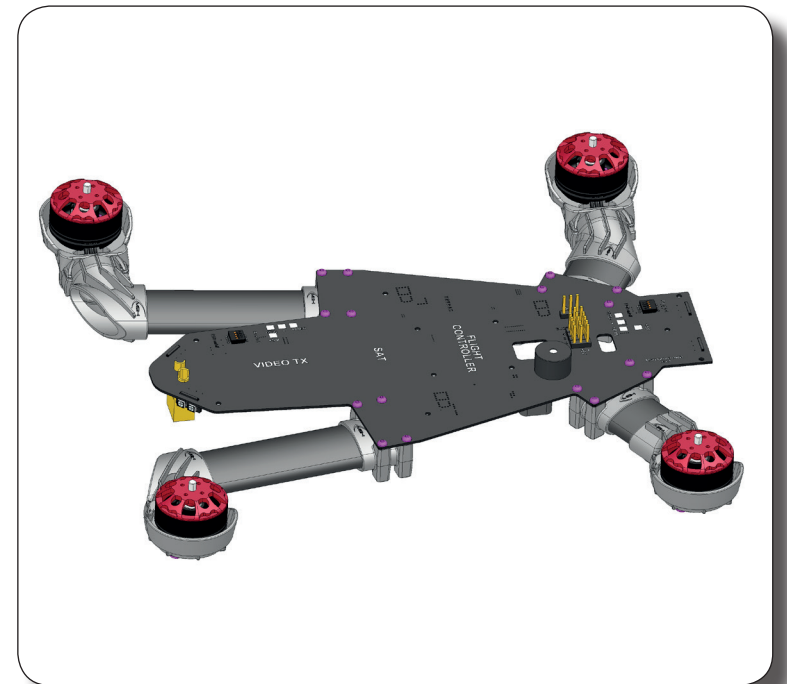
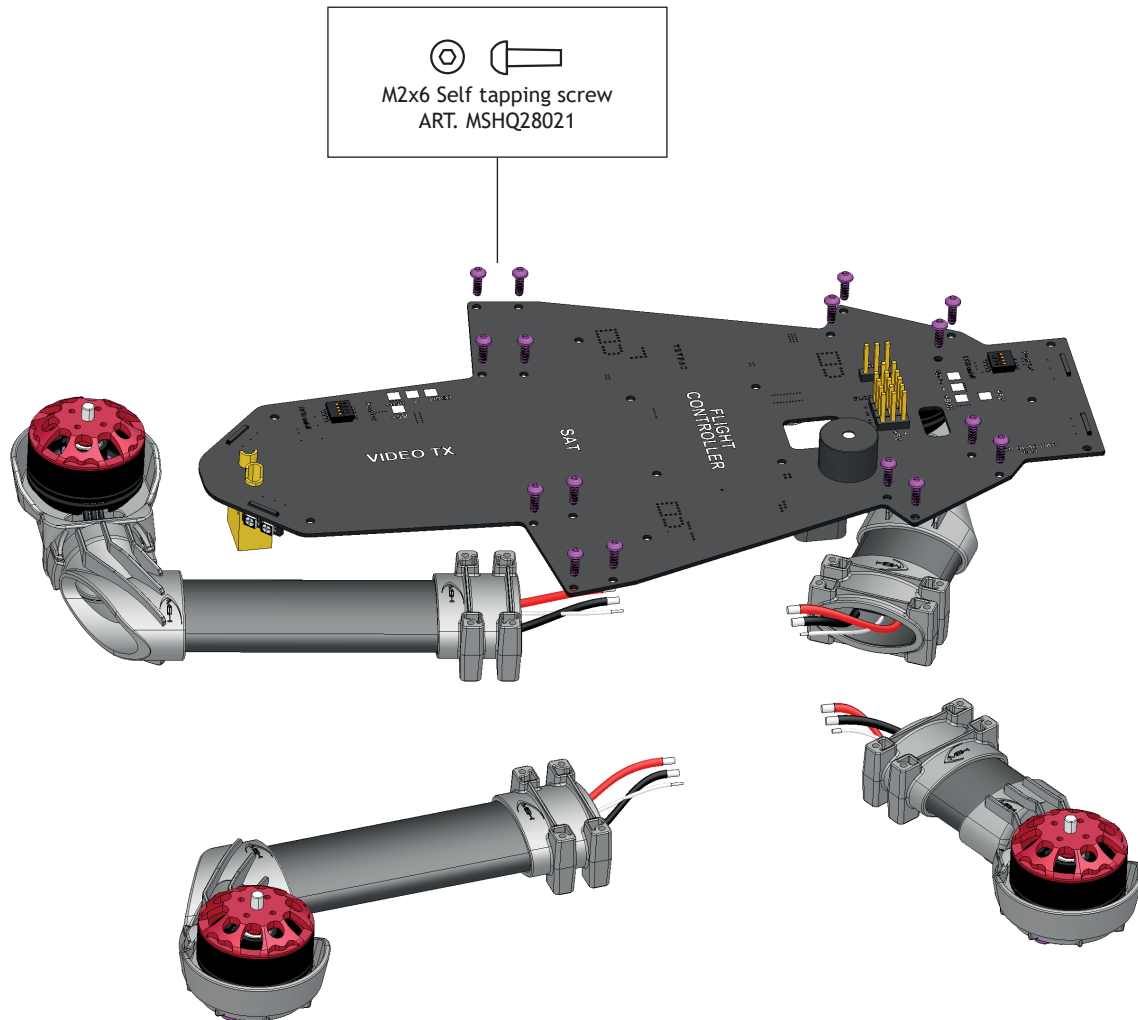

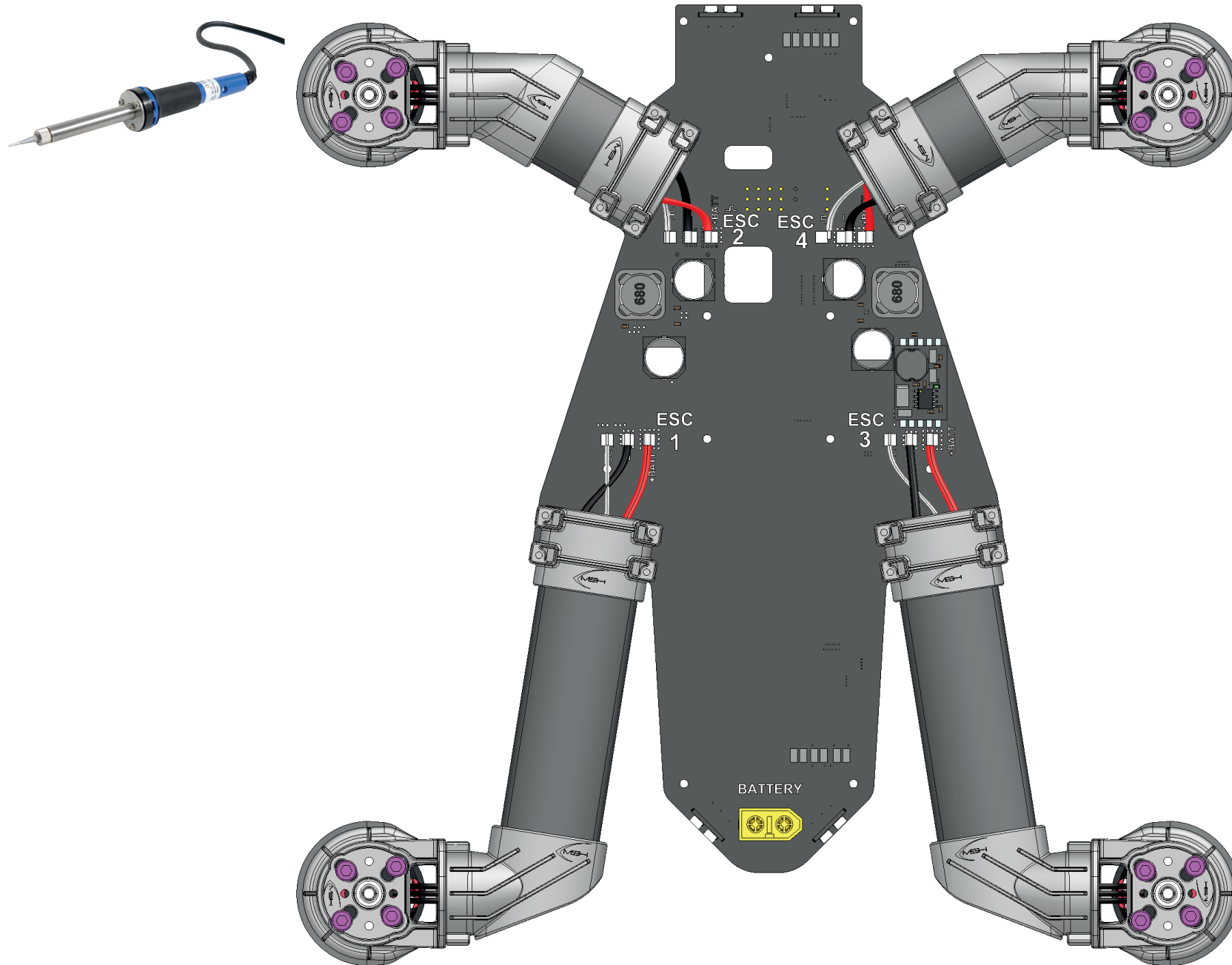

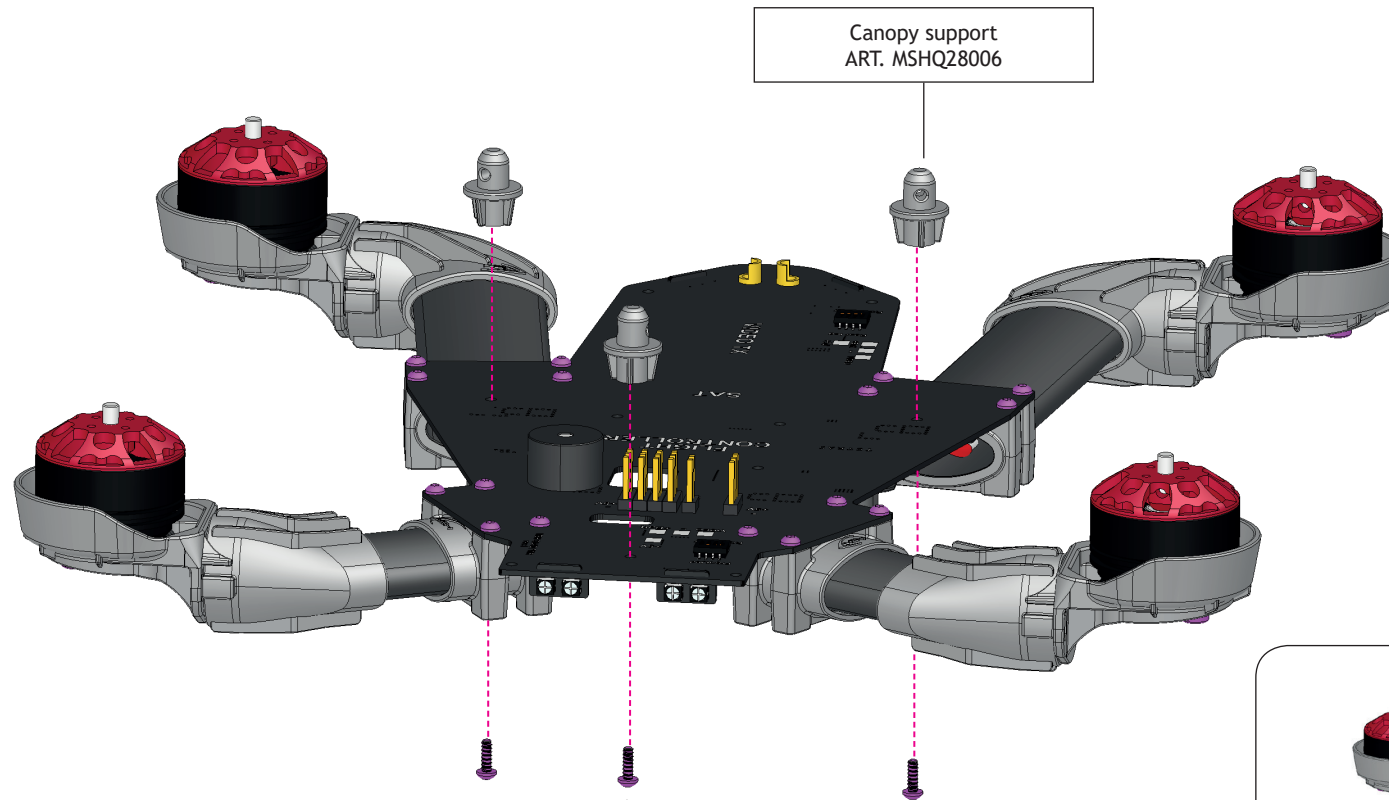

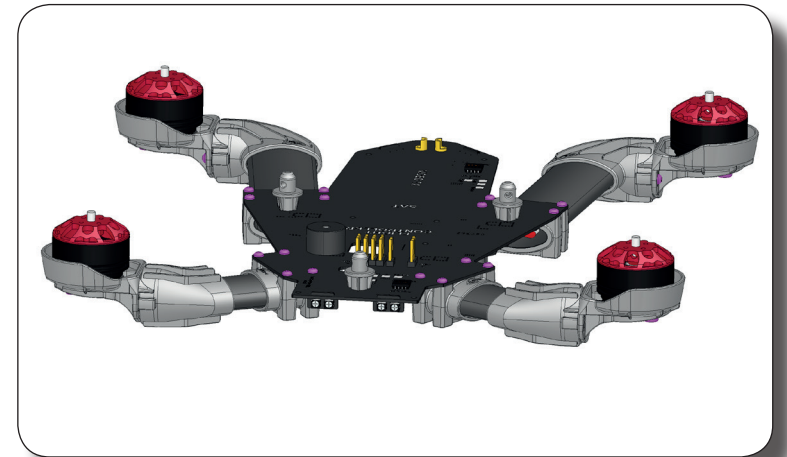

 M2x6 Self tapping screw
 ART. MSHQ28021
 ART. MSHQ28006

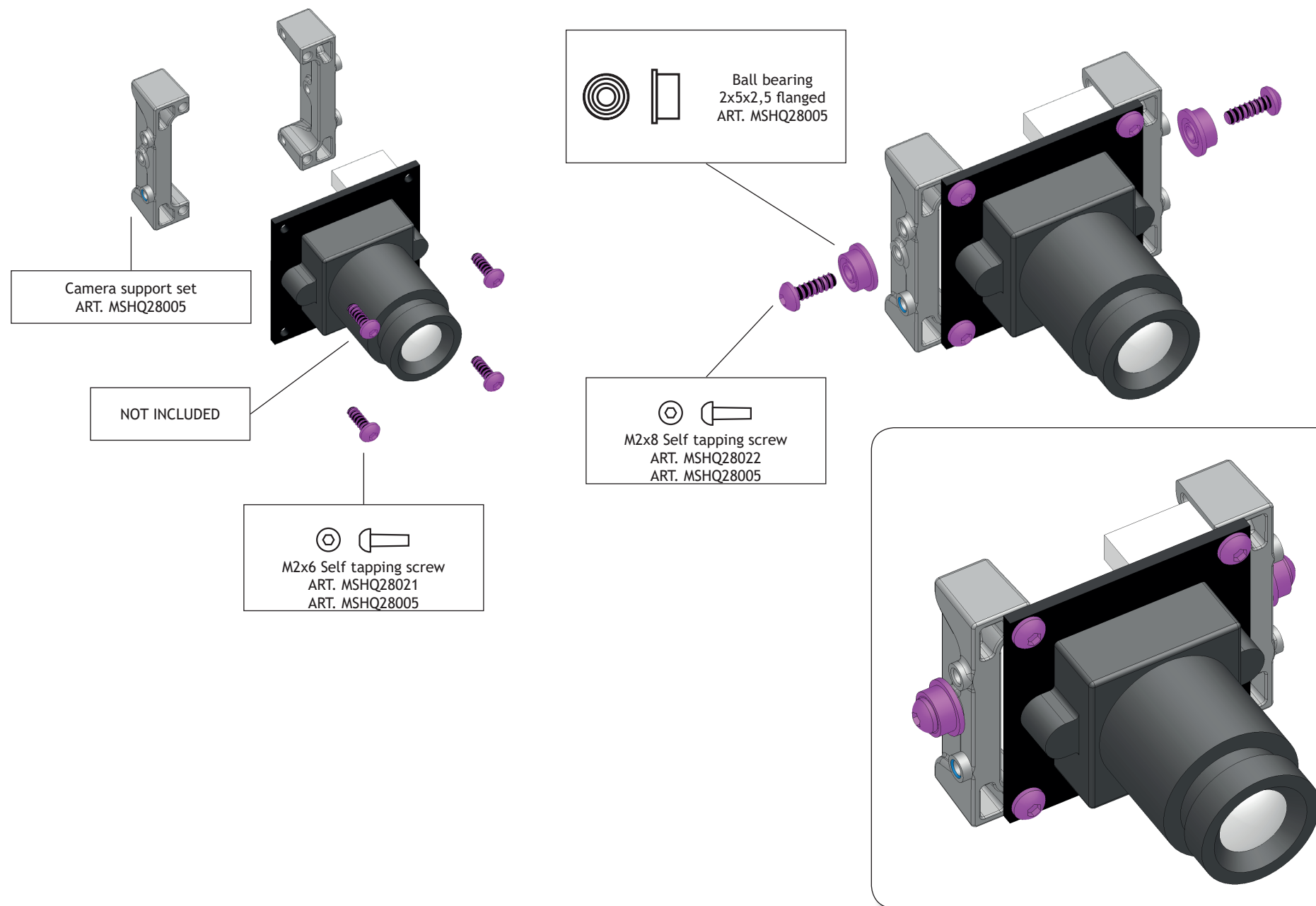

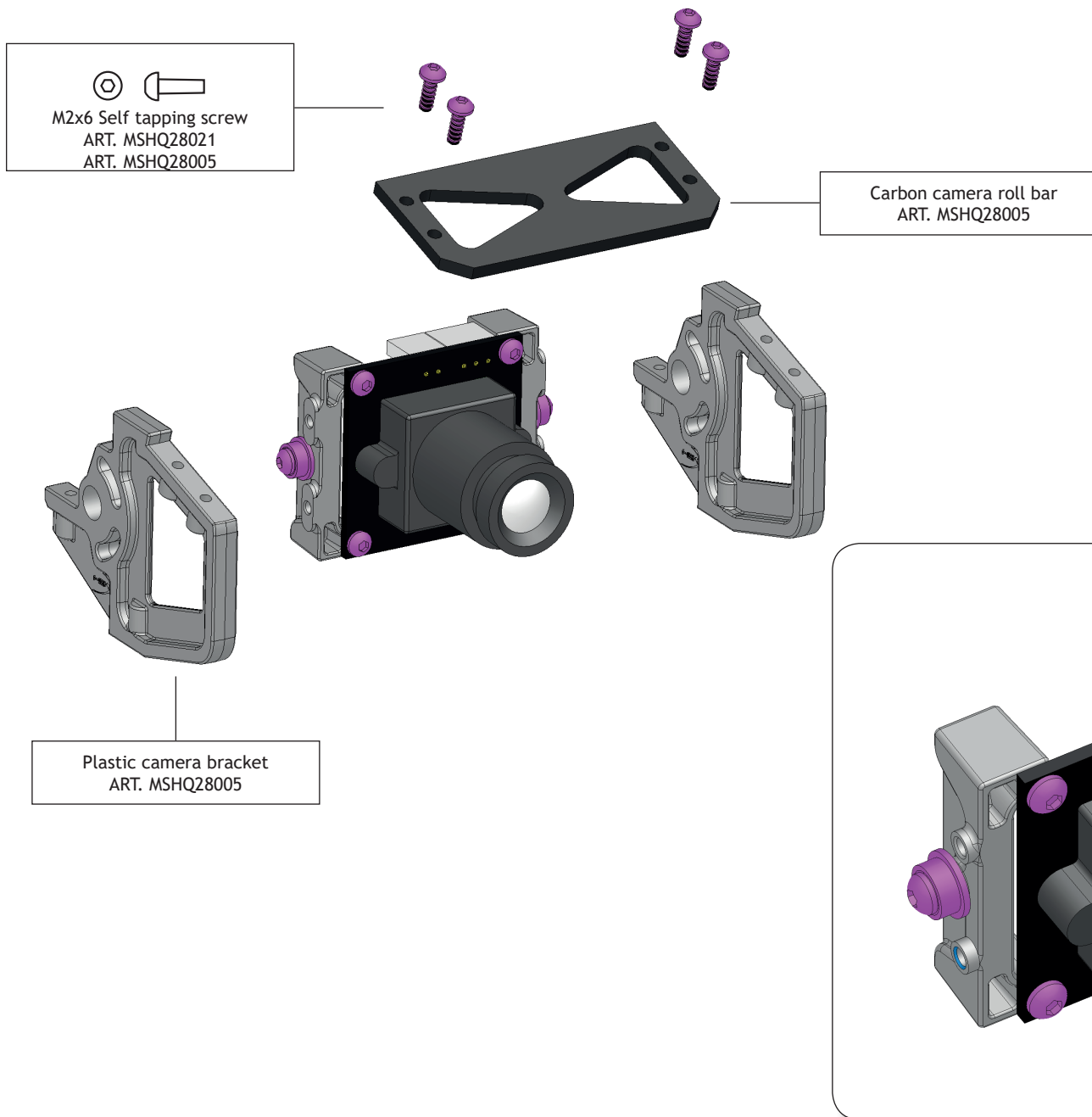

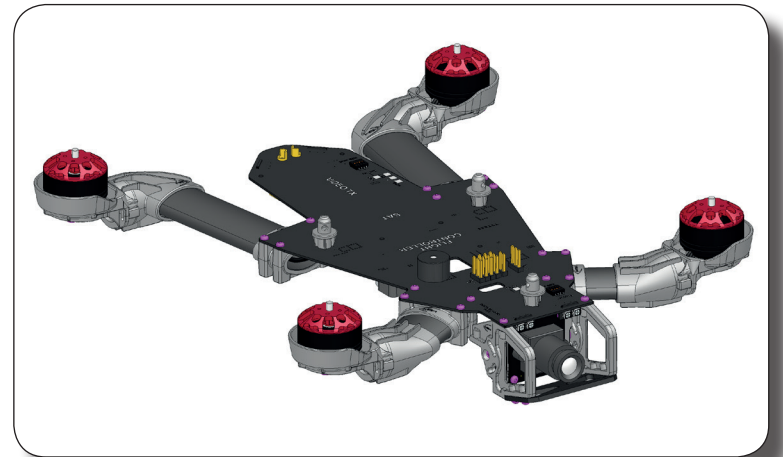
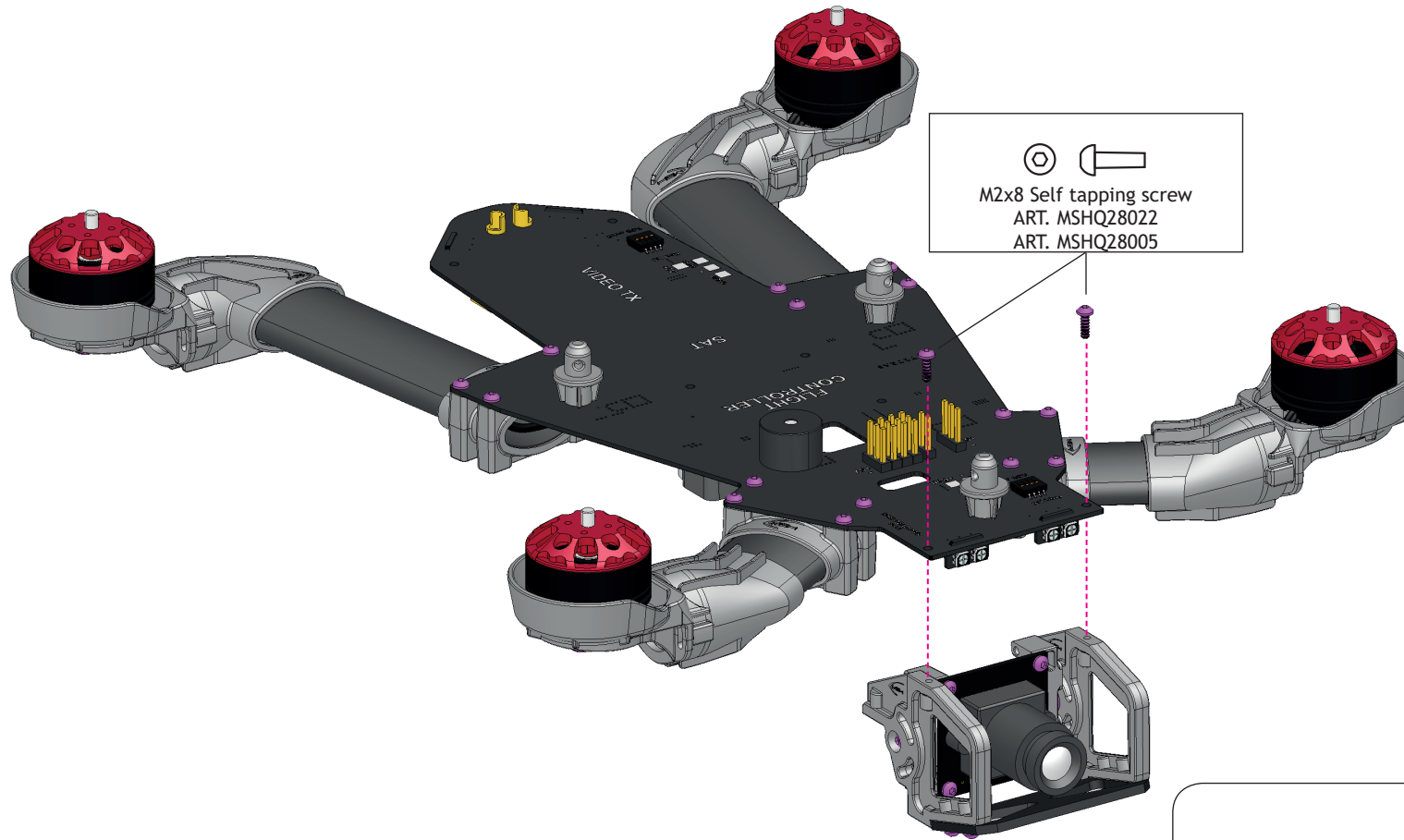

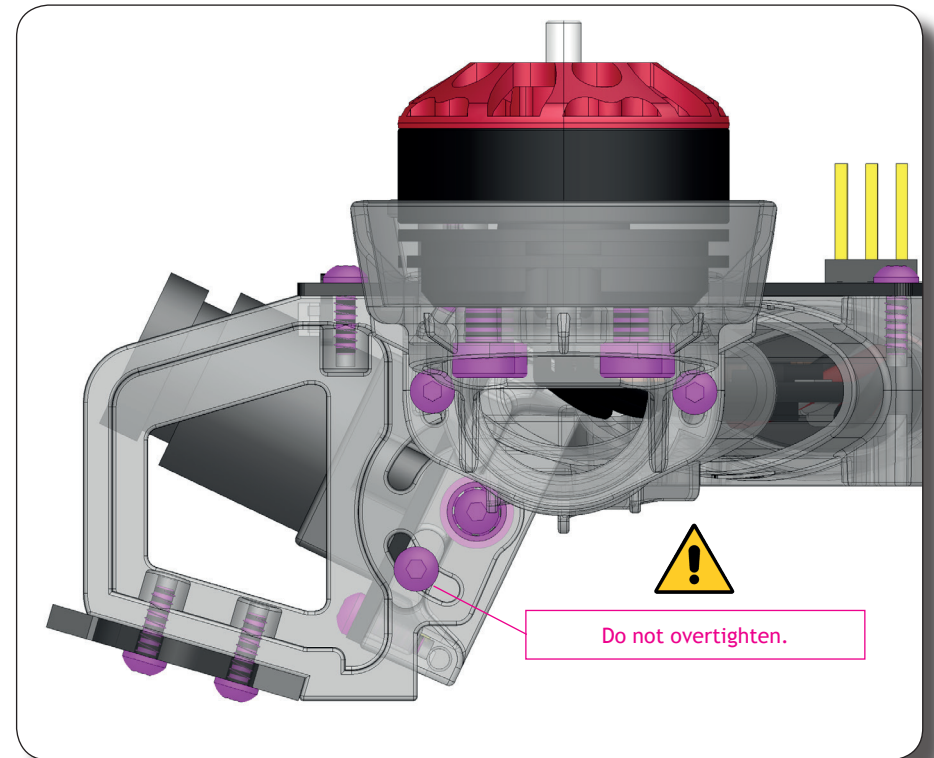
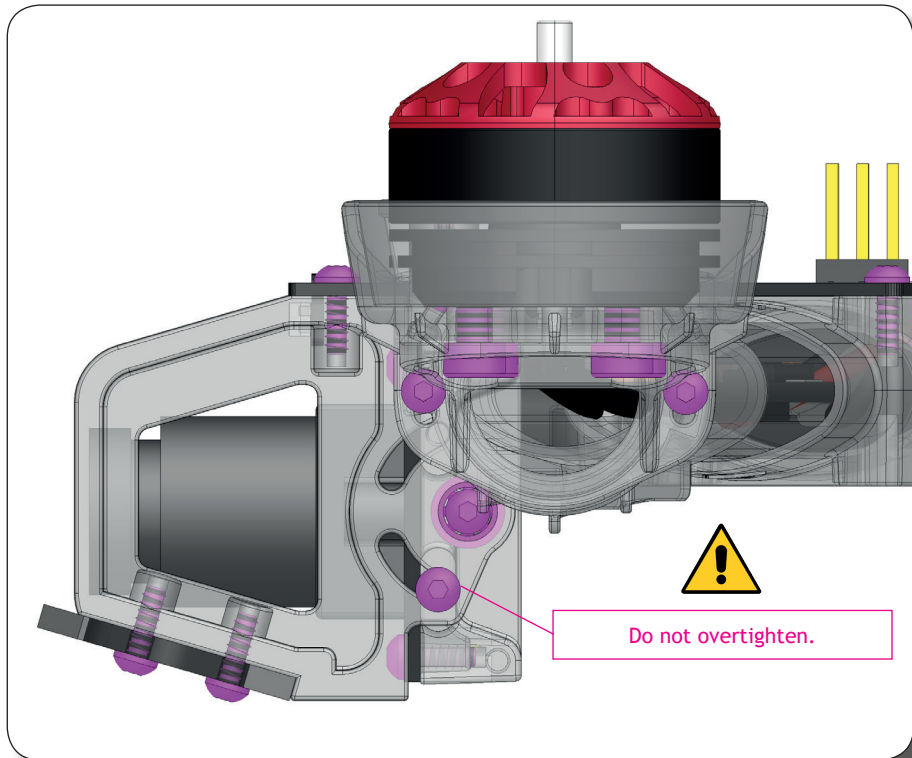
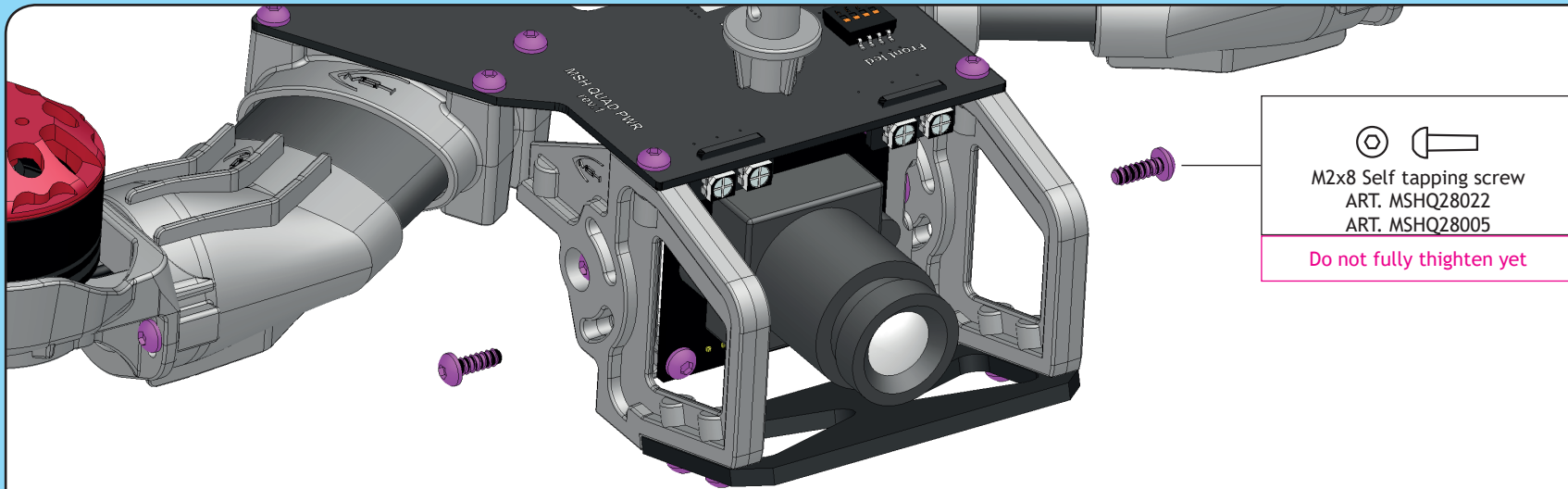



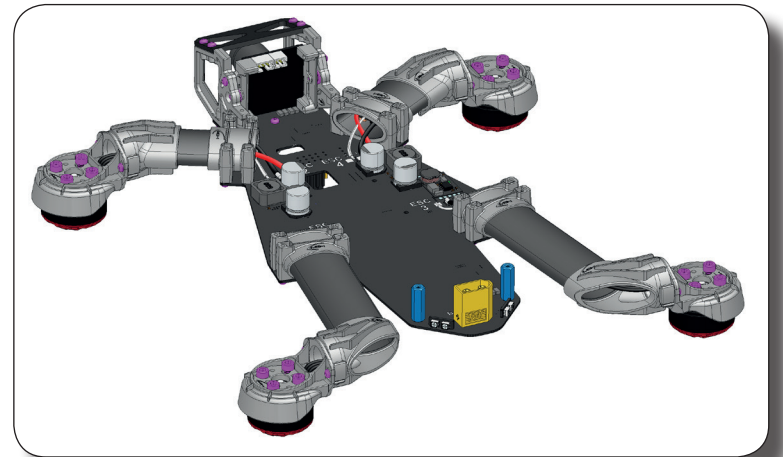
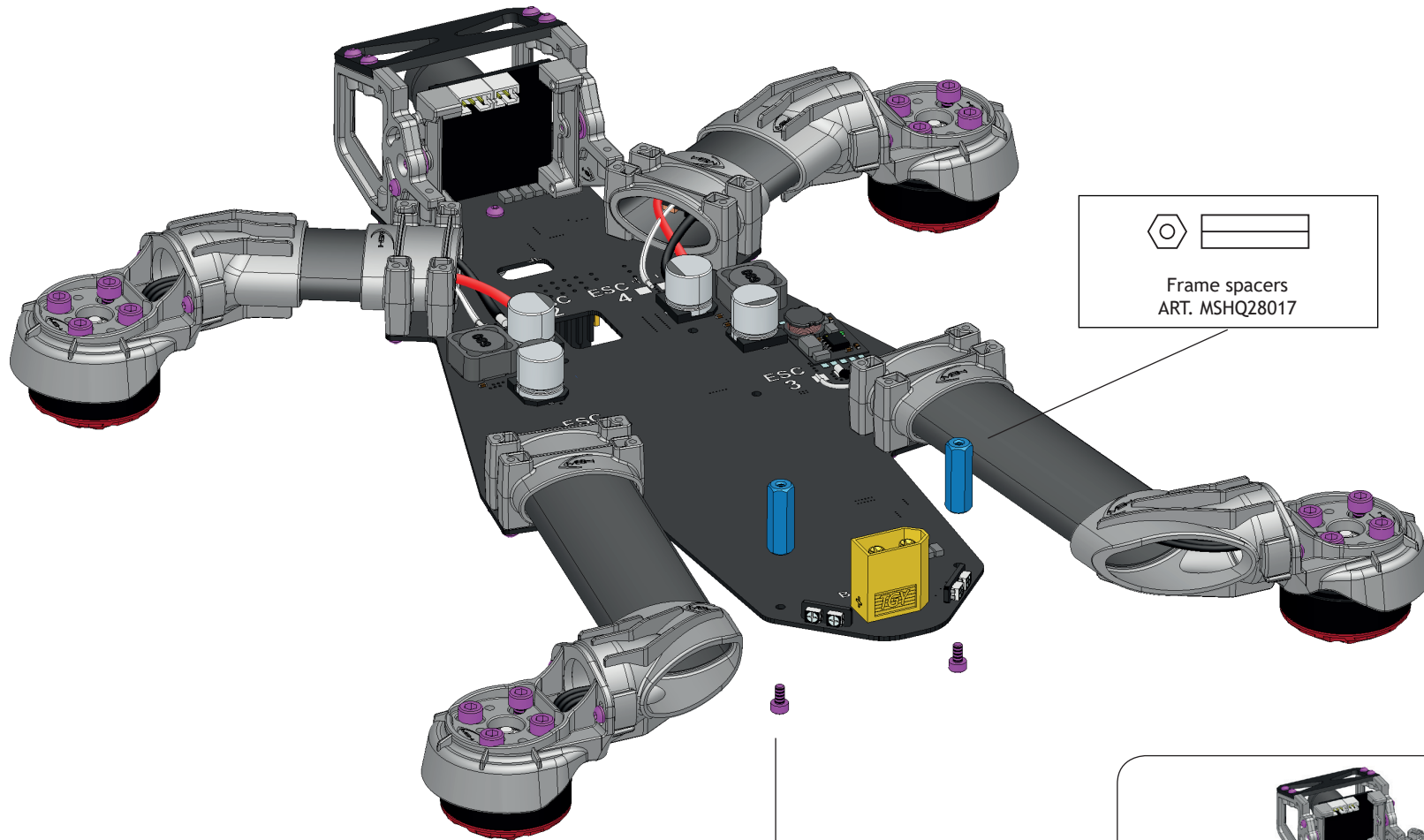

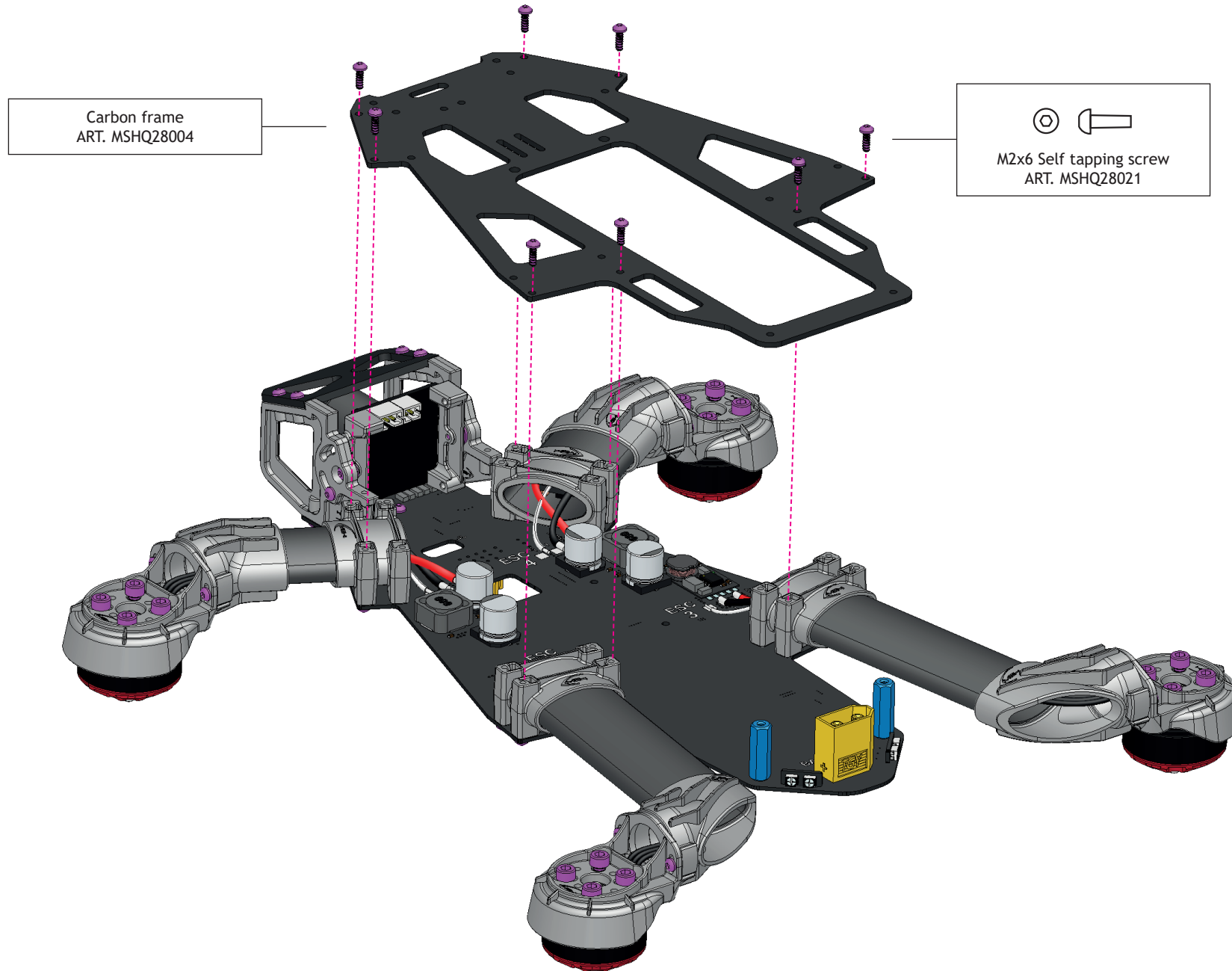

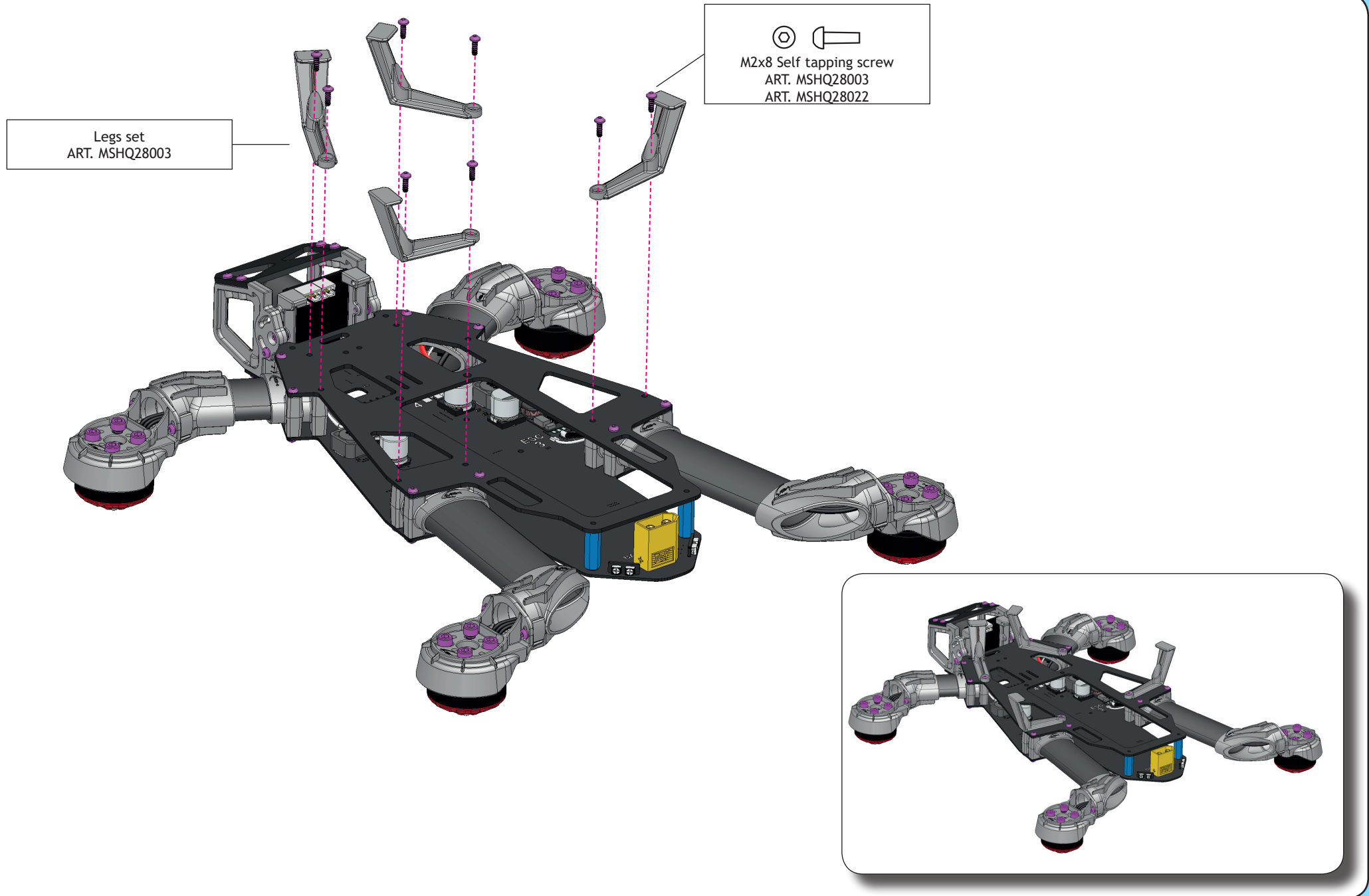

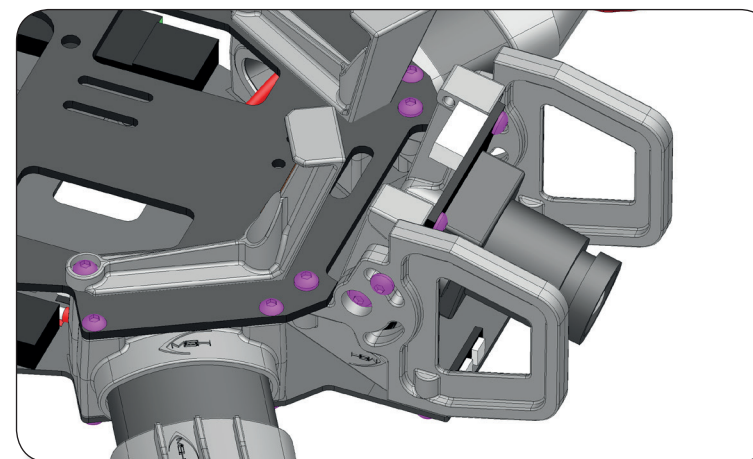
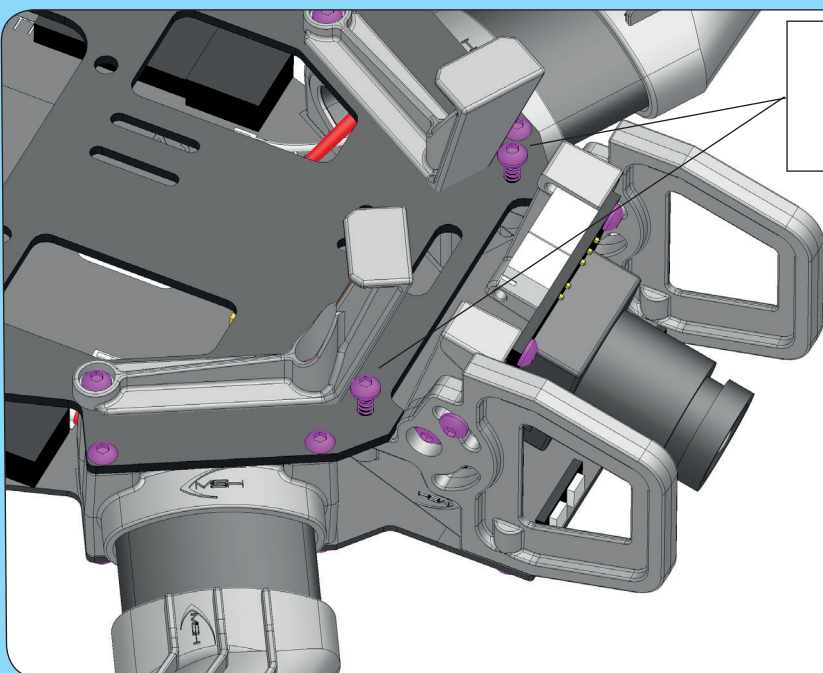
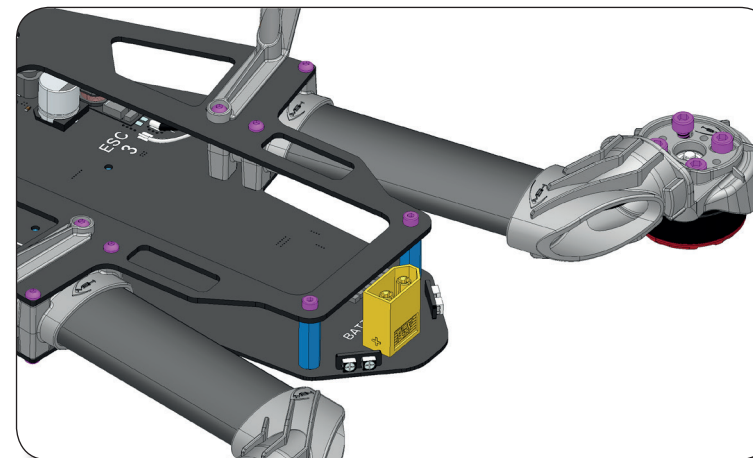
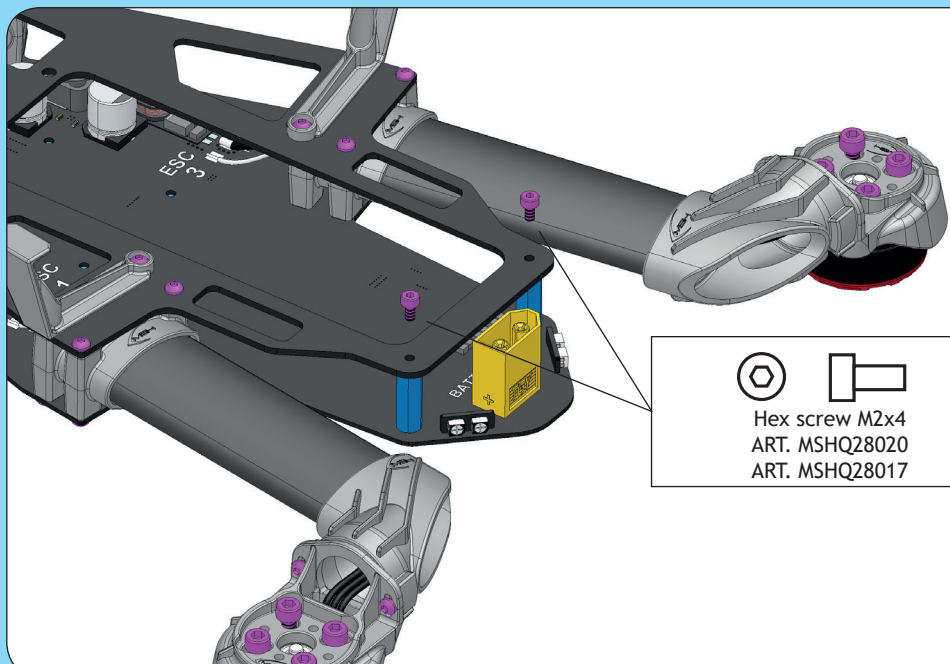

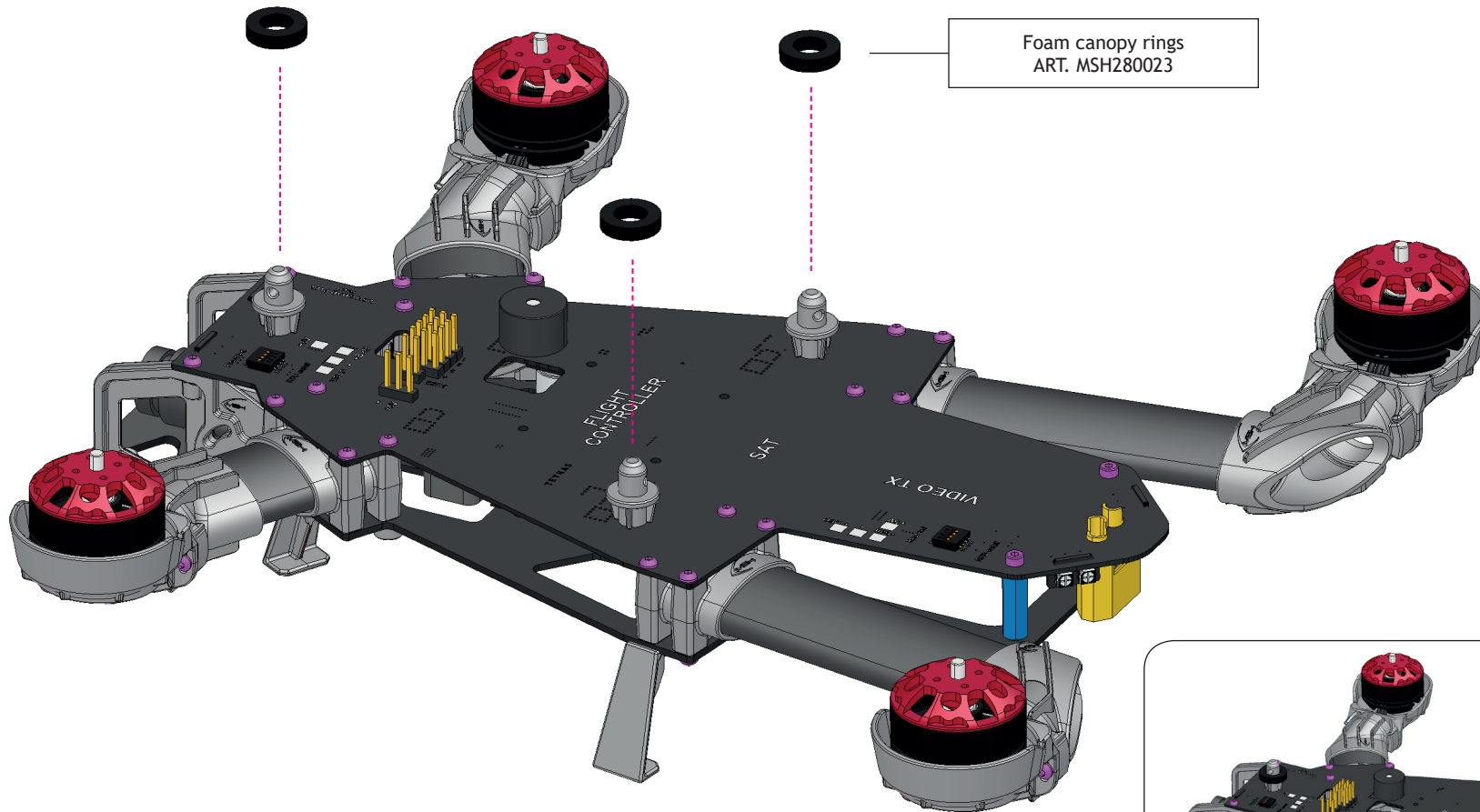

Foam canopy rings
ART. MSH280023

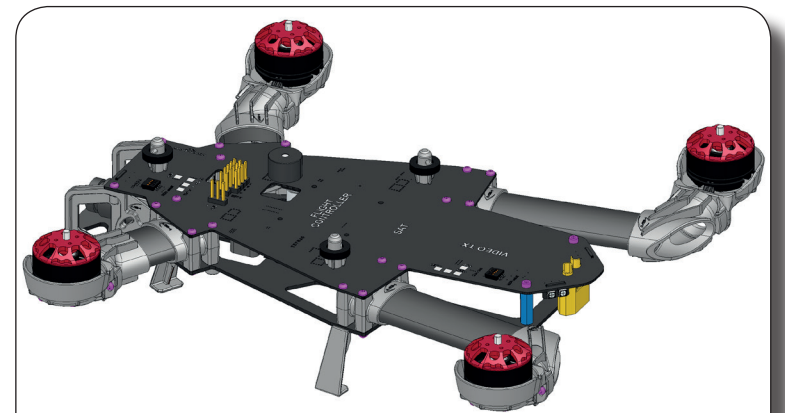

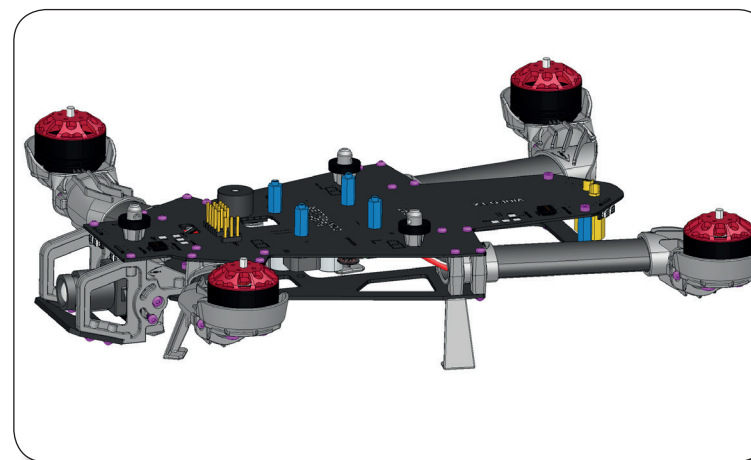
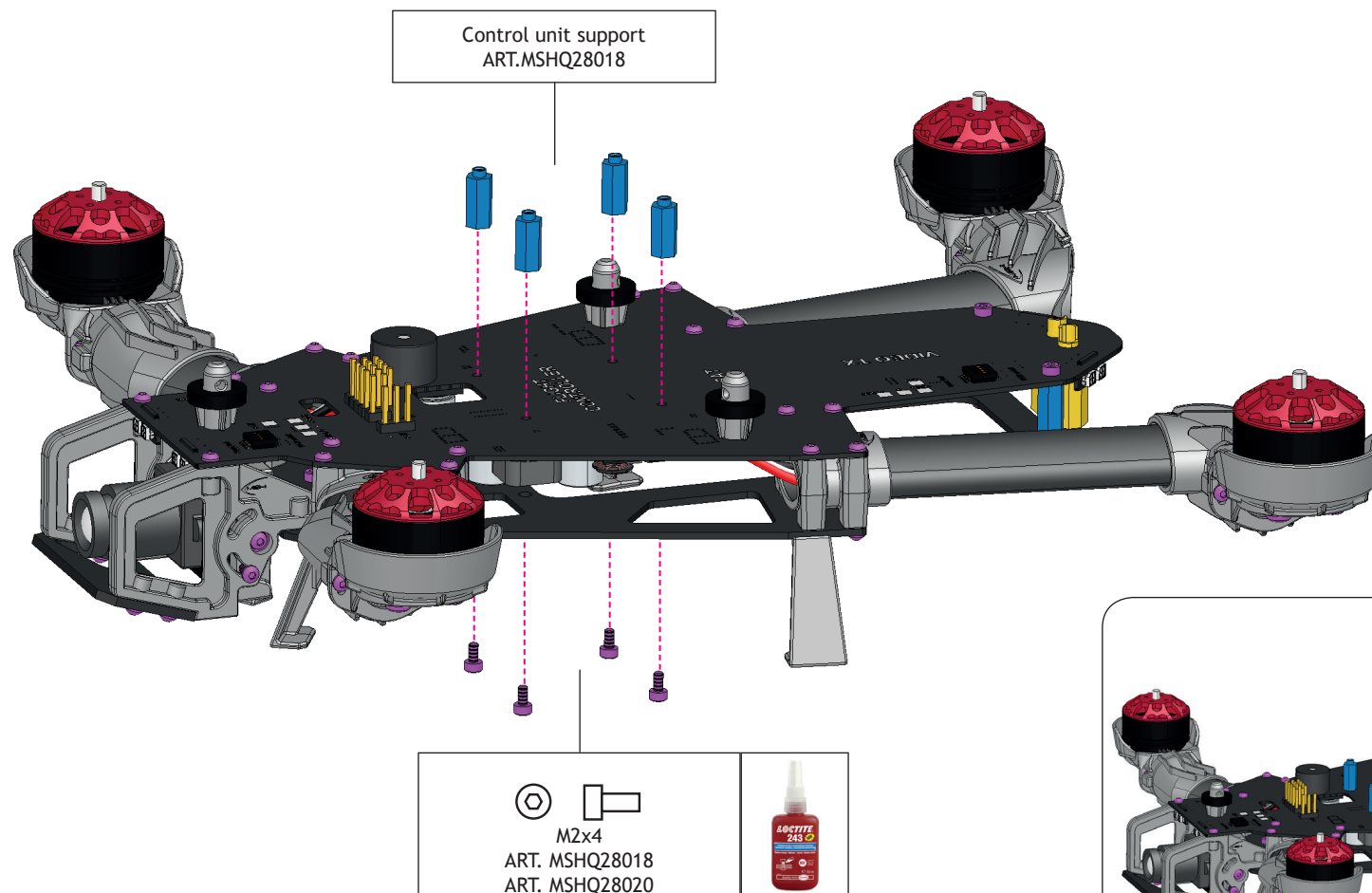

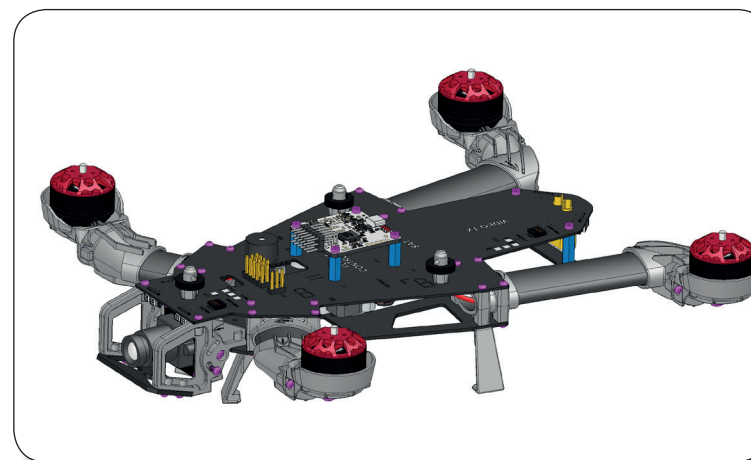
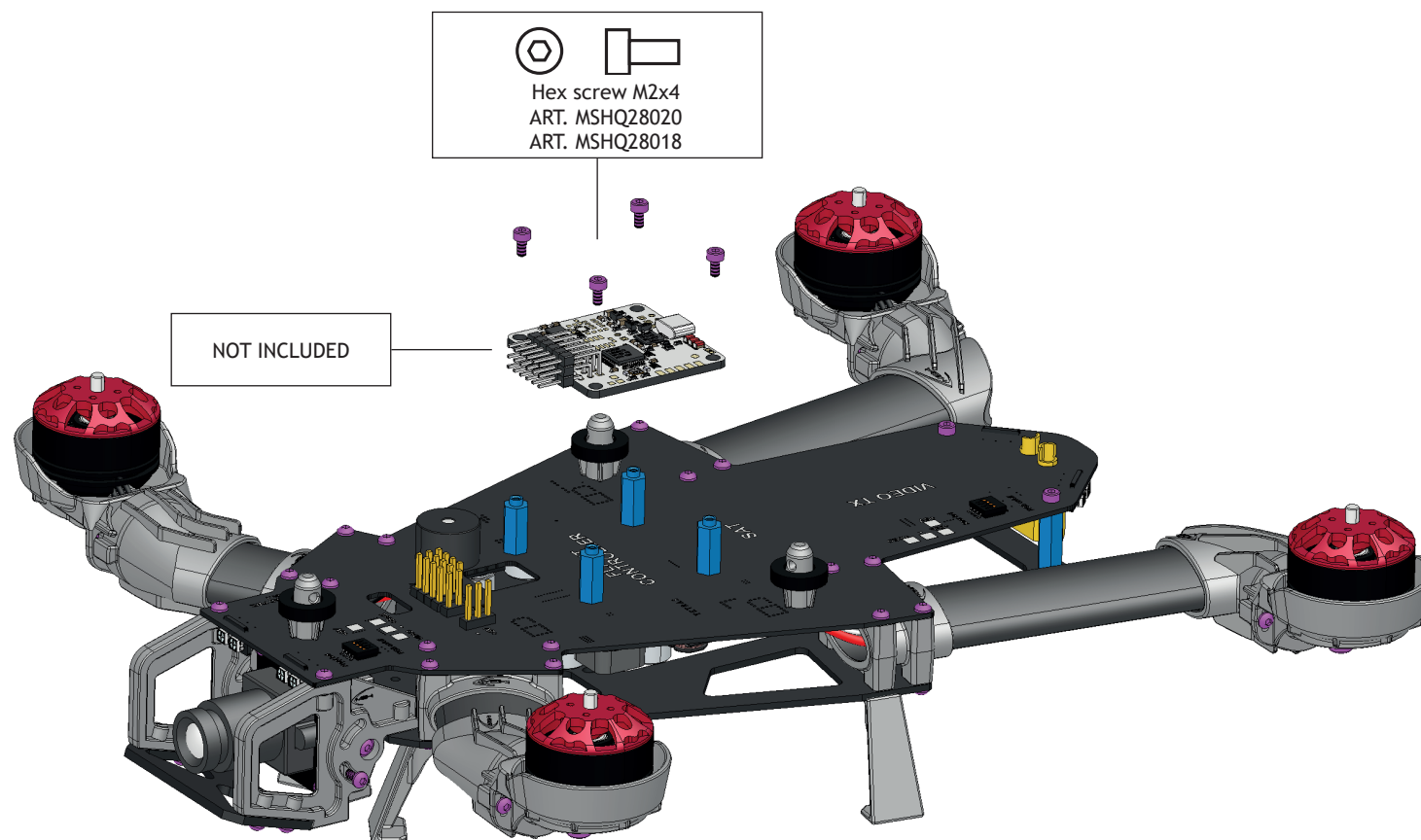

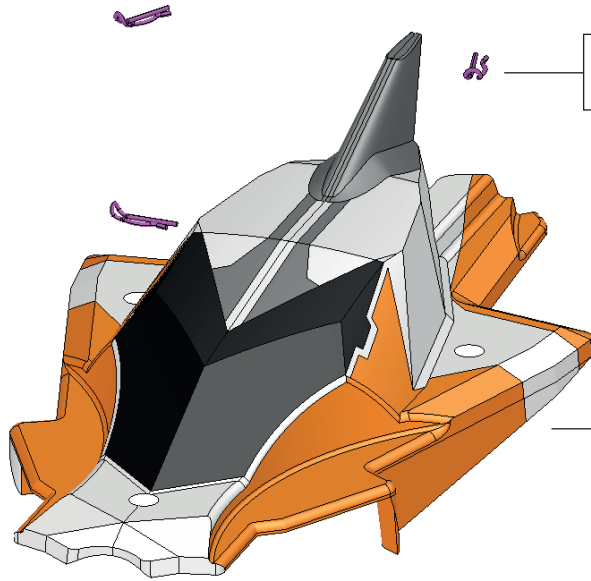

Canopy clip
ART.MSHQ28007

Canopy
ART.MSHQ28013 Red
ART.MSHQ28014 Yellow
ART.MSHQ28015 Orange
ART.MSHQ28016 Clear

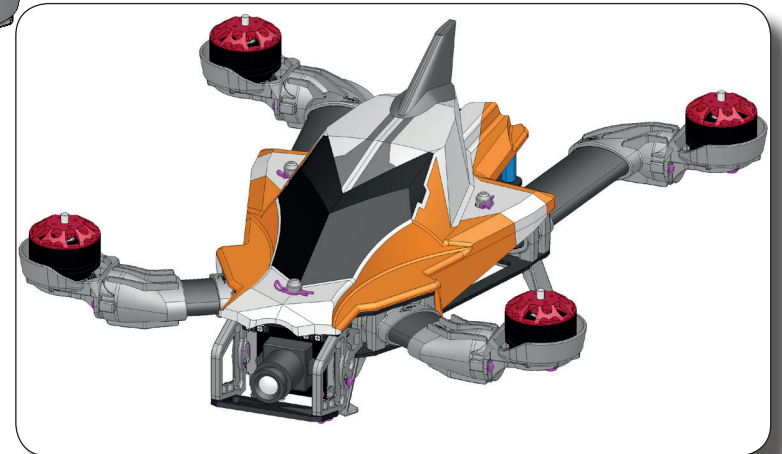
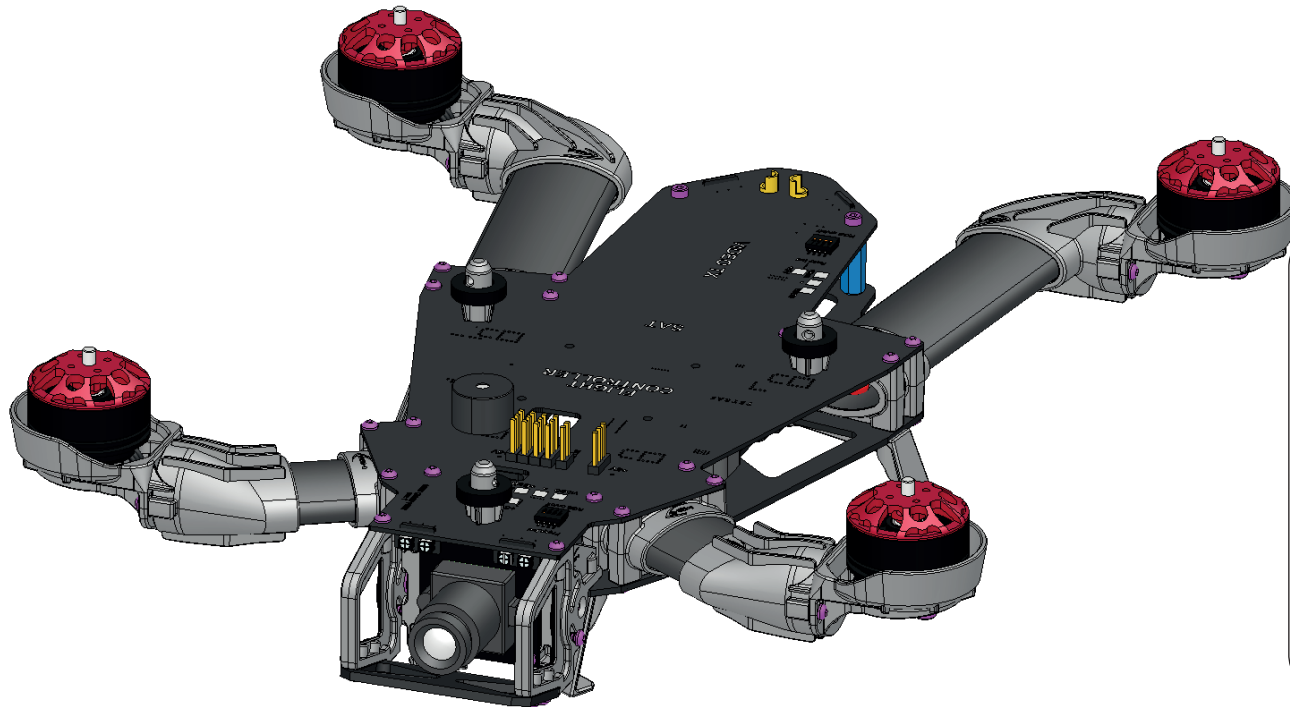

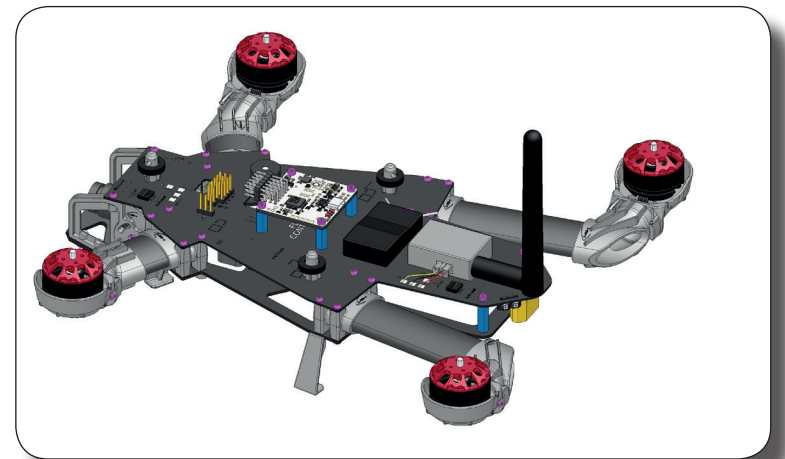
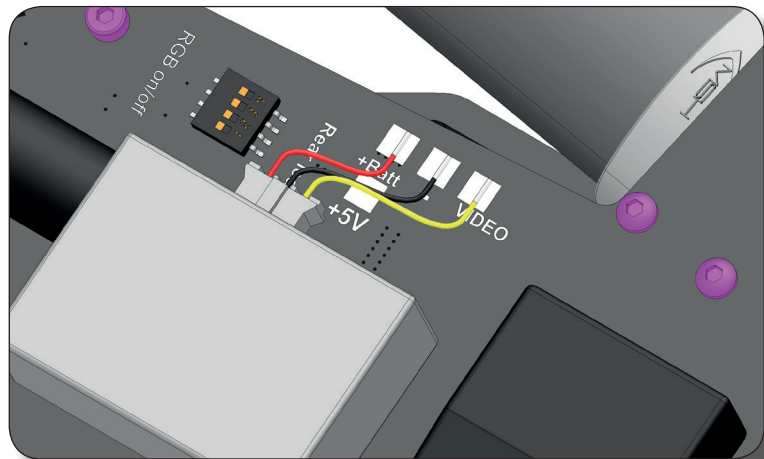
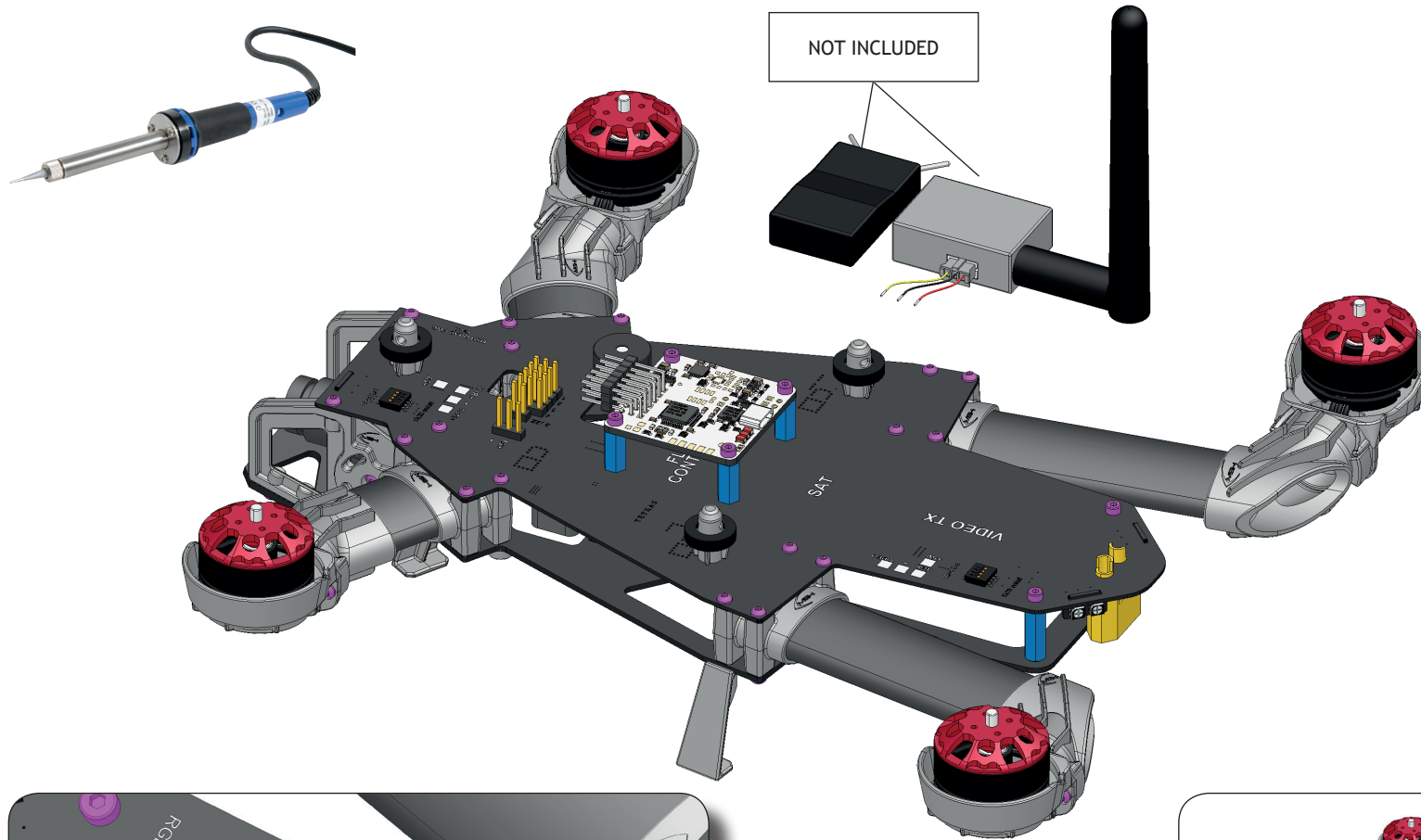

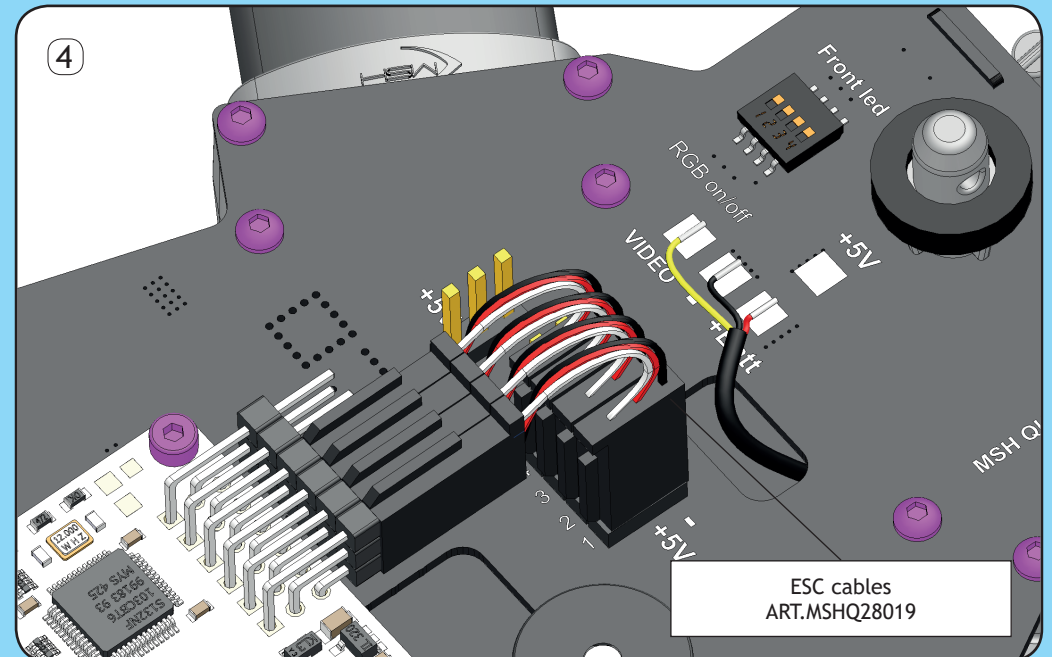
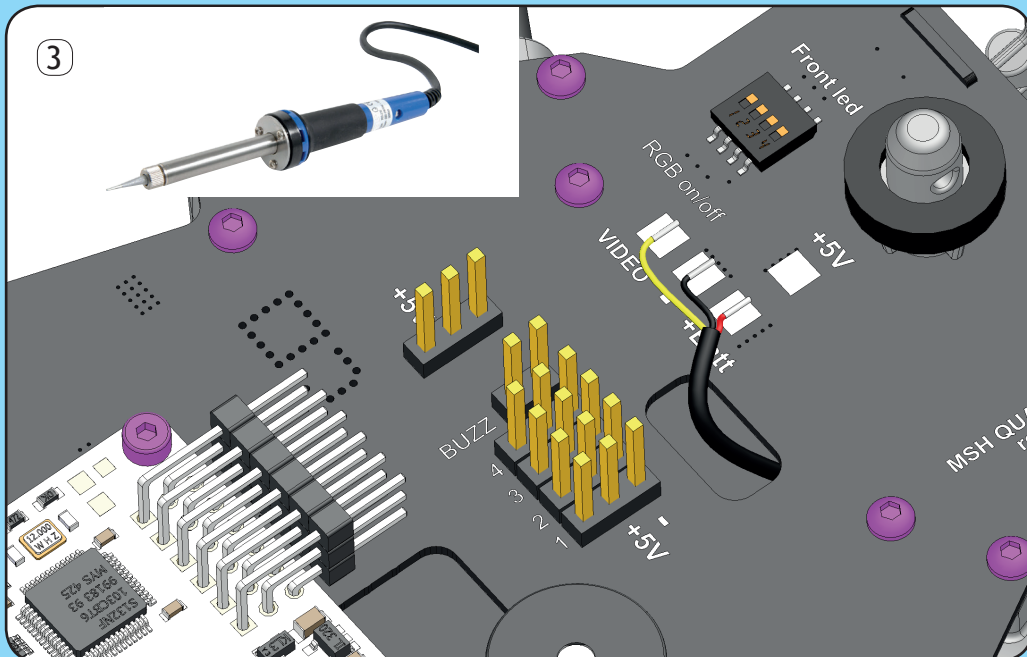
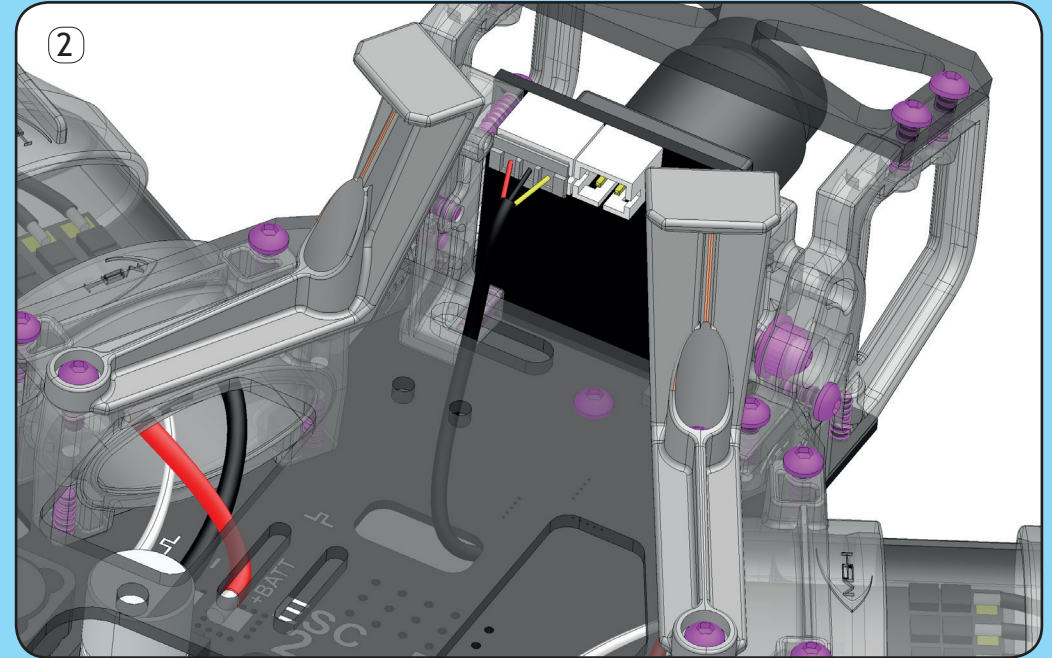
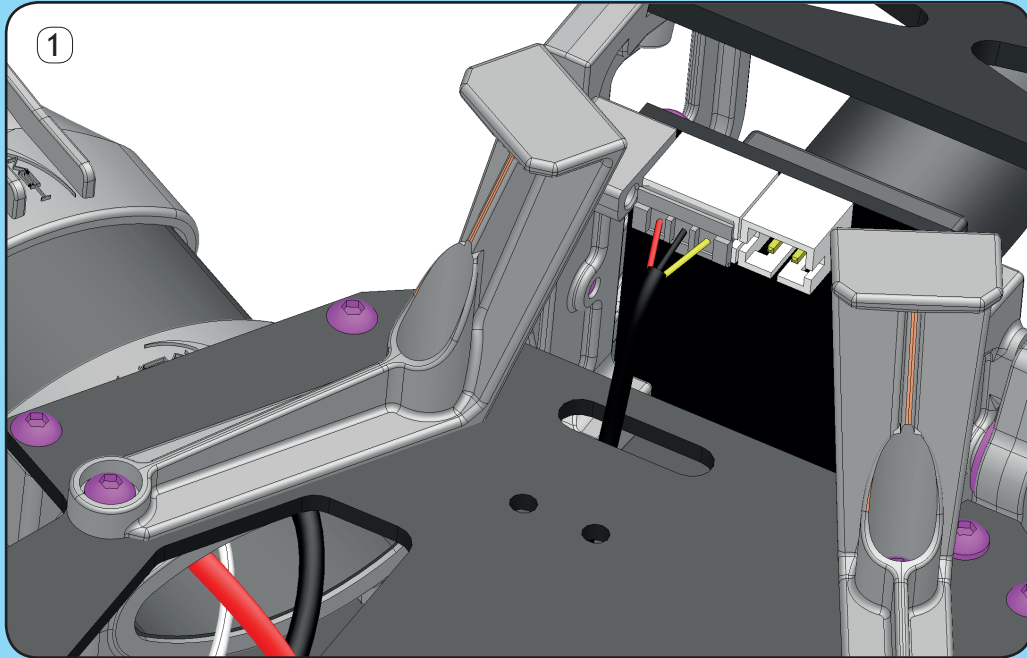

ESC cables
ART.MSHQ28019

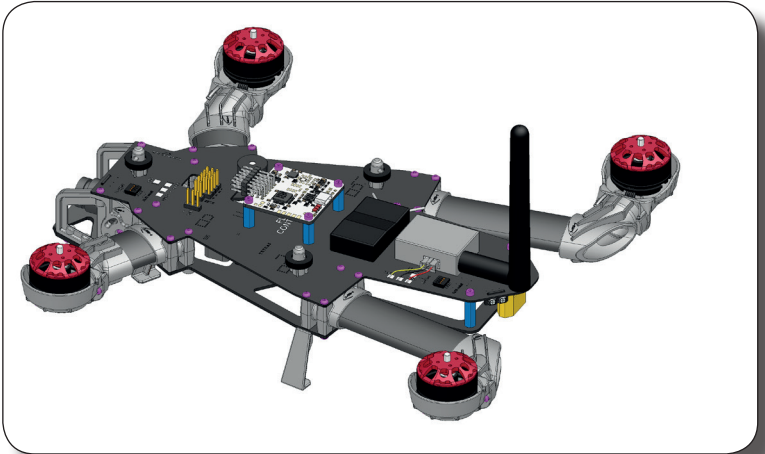
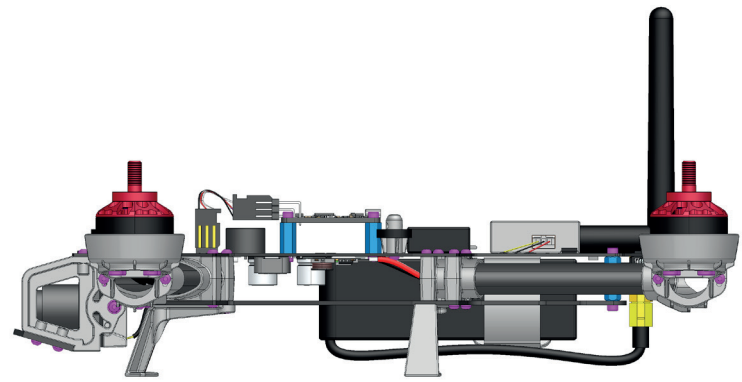
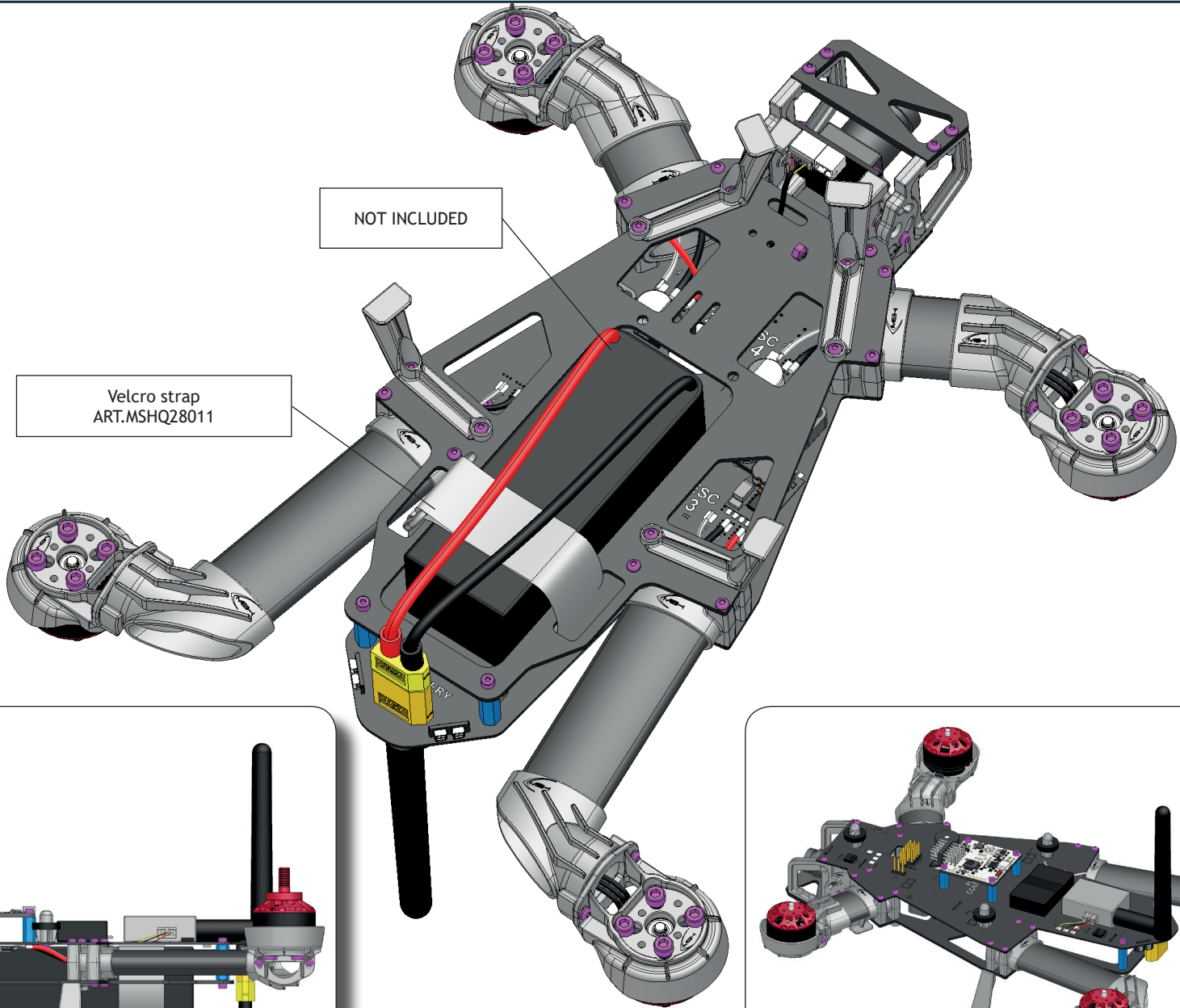

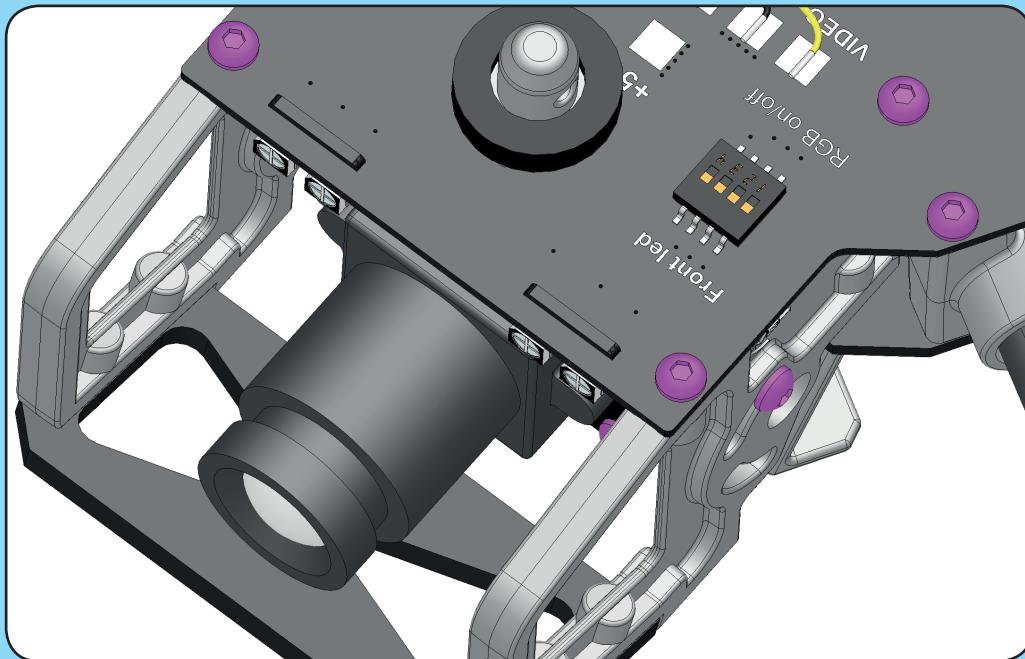
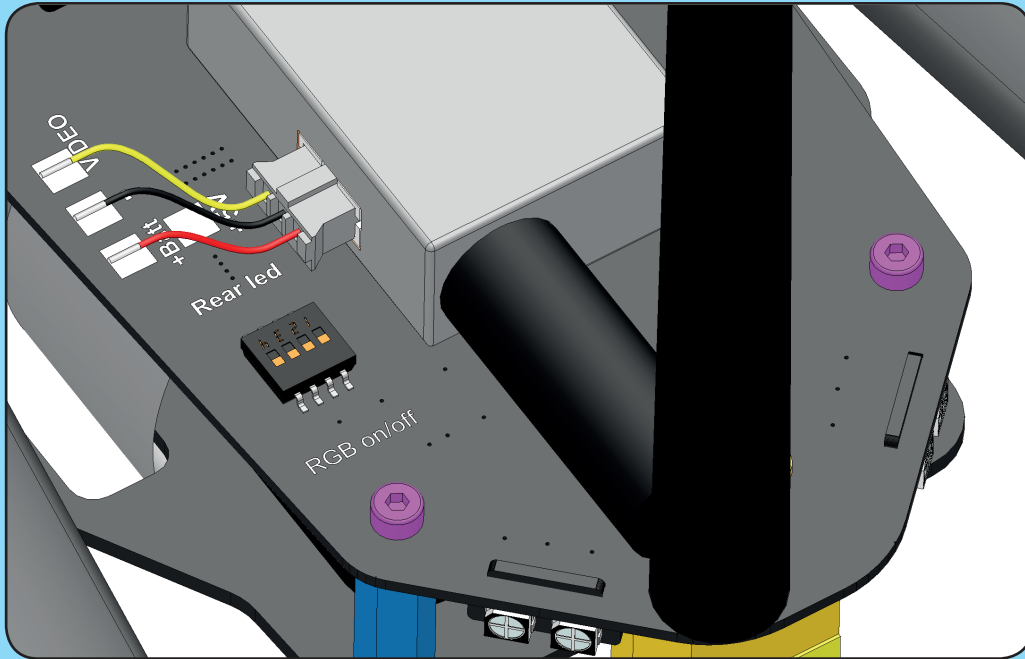

1	2	3	4
---	---	---	---



Purple



Blue



Light blue



White



Light green



Green



Red

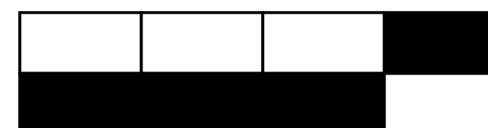

Off

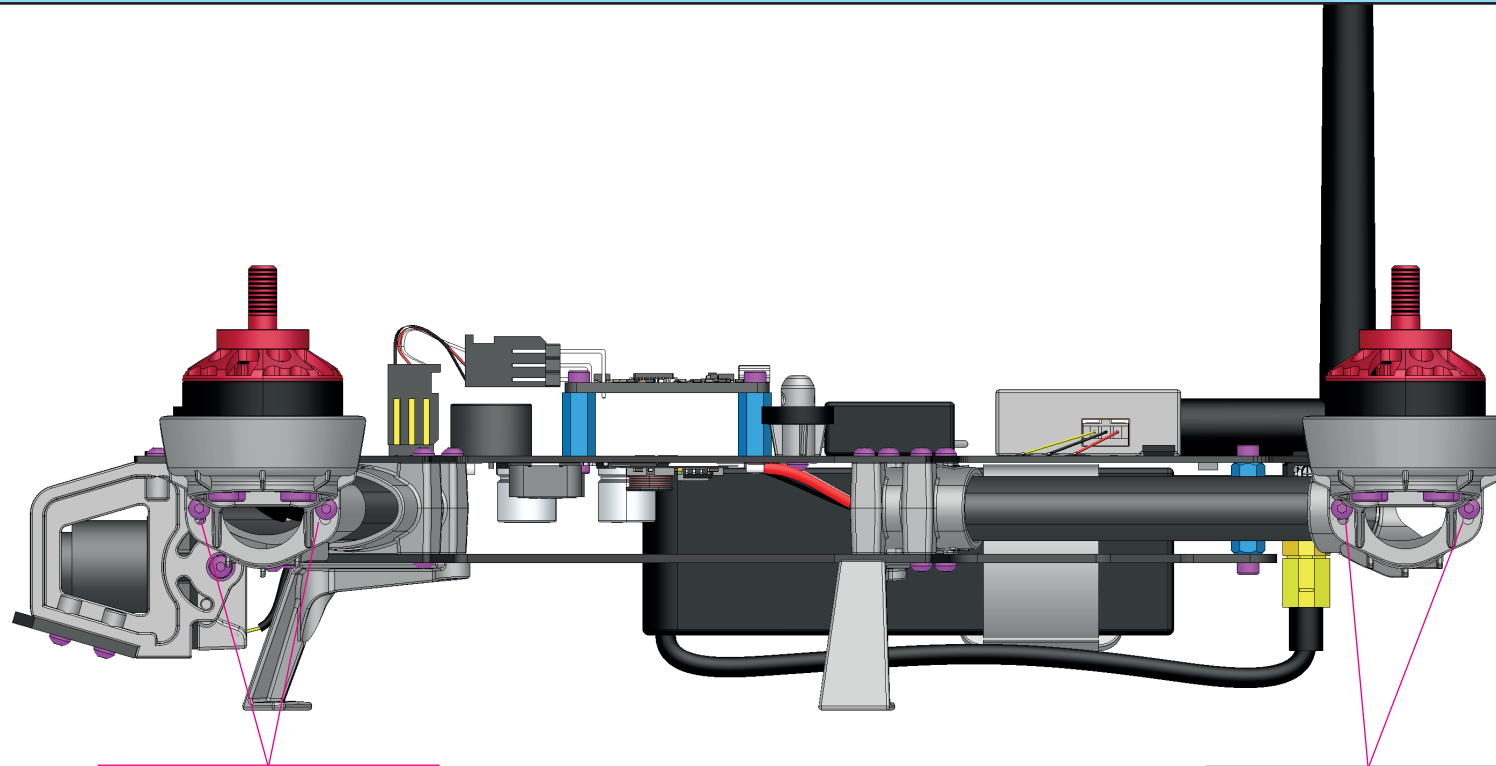

Tighten completely

Tighten completely

0° motor inclination

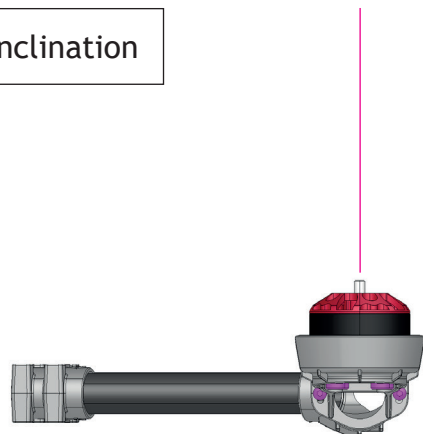
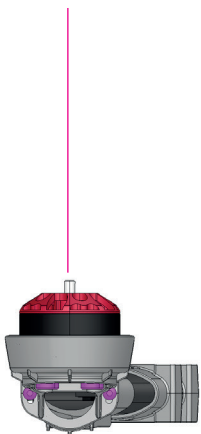

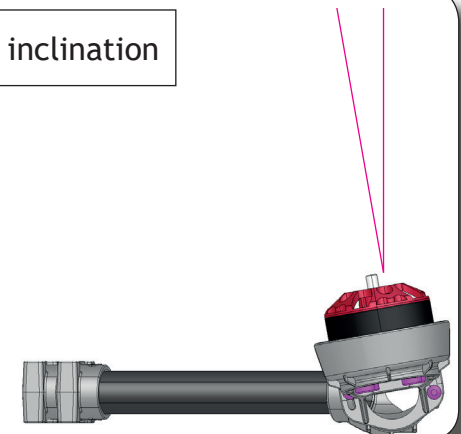
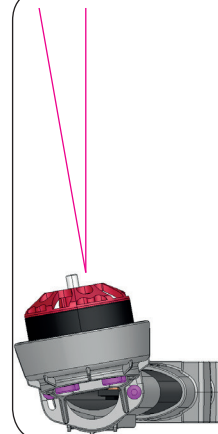

10° motor inclination

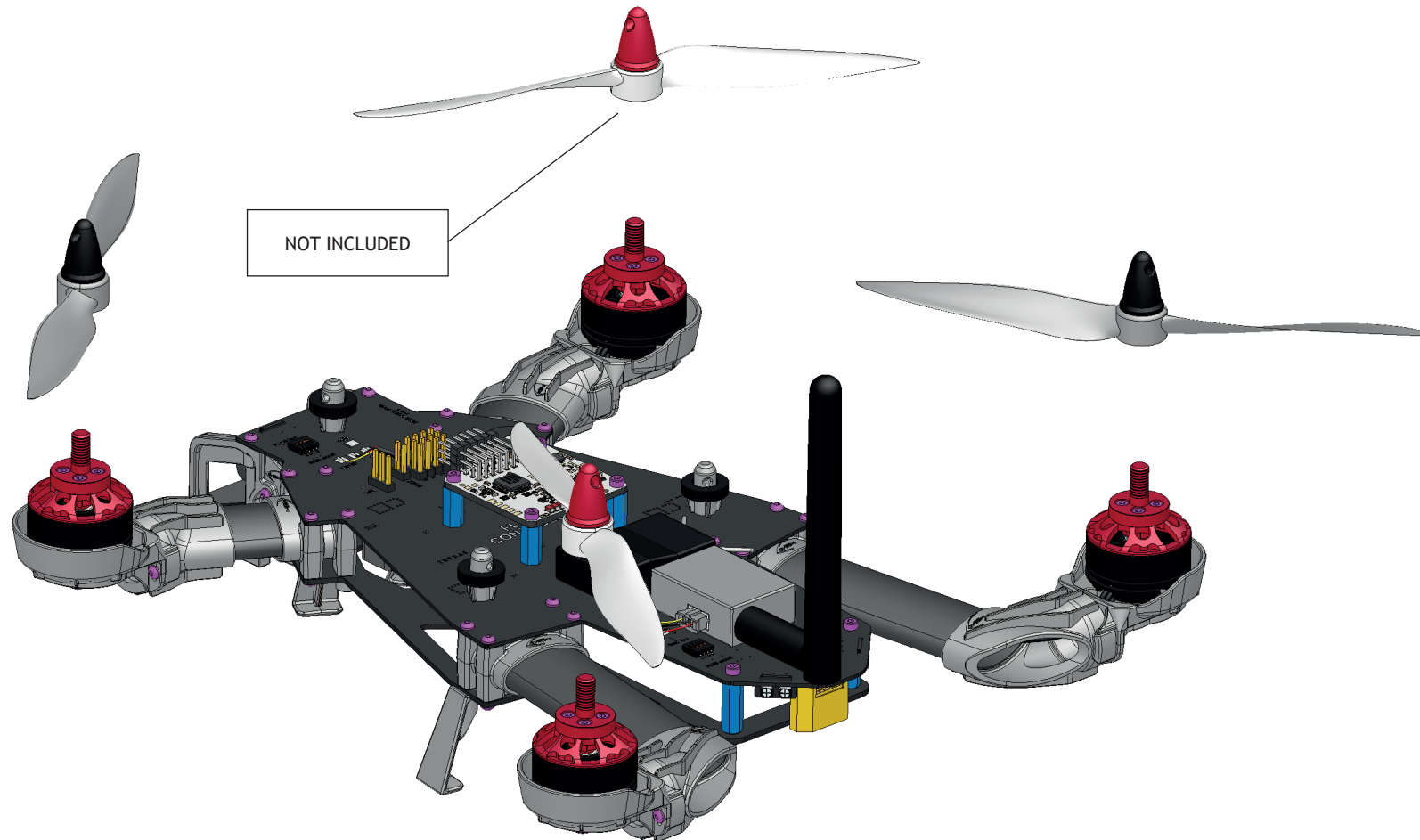

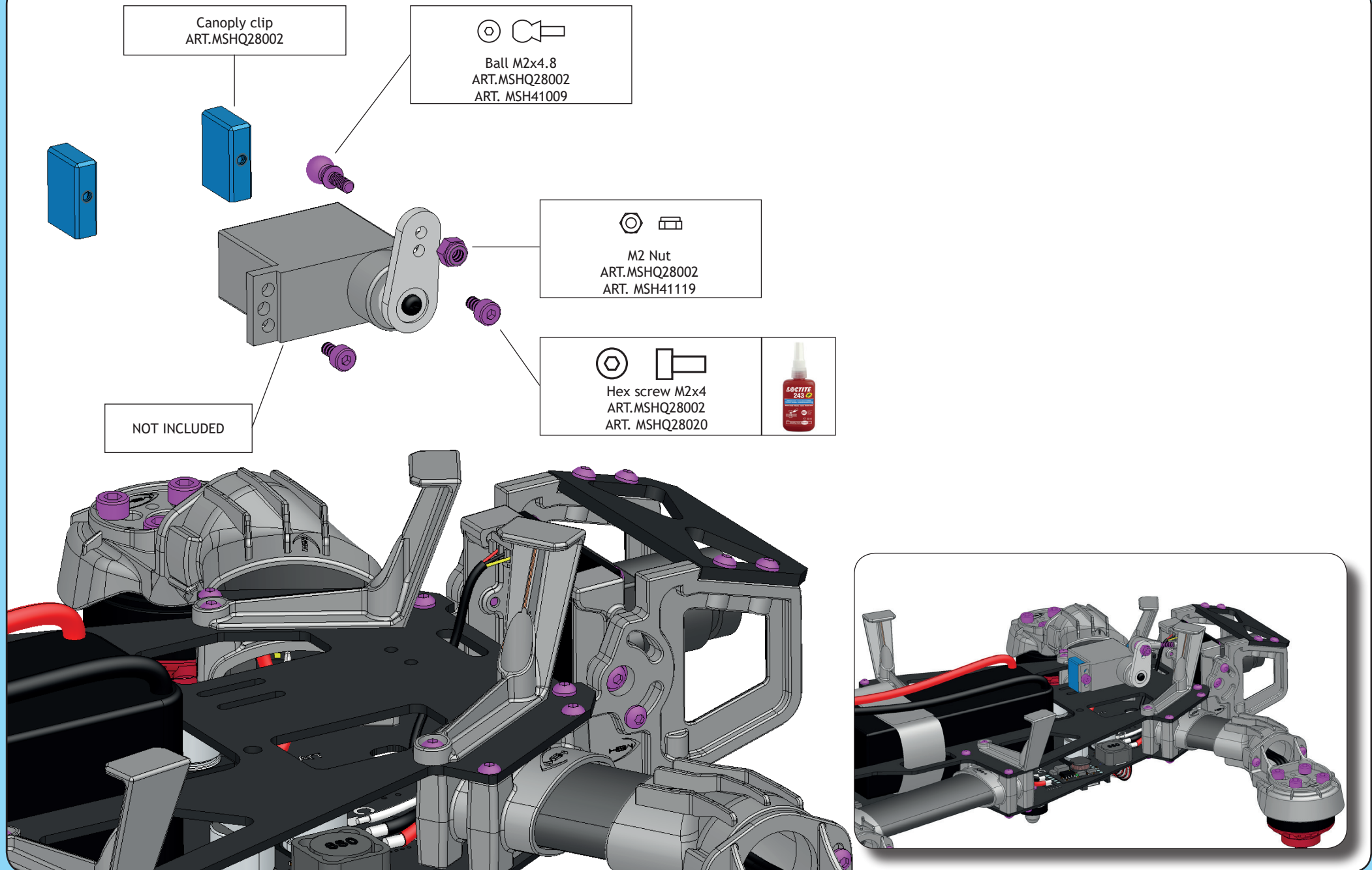

Be careful !
please check your setup before
installing propellers.



Ball M2x4.8
ART.MSHQ28002
ART. MSH41009

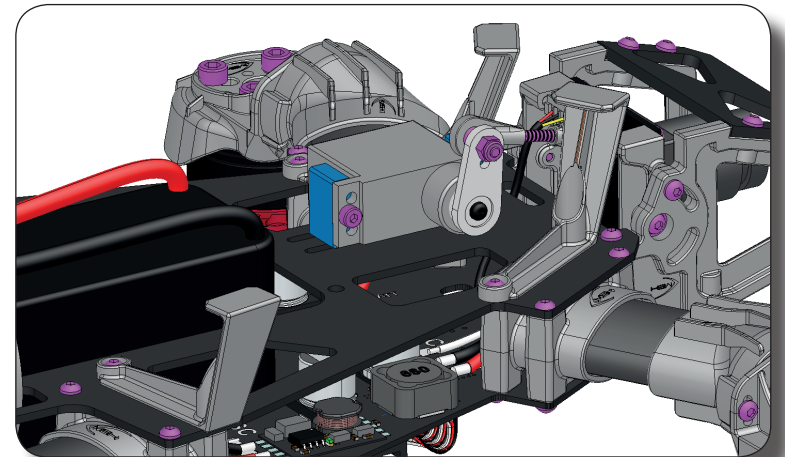
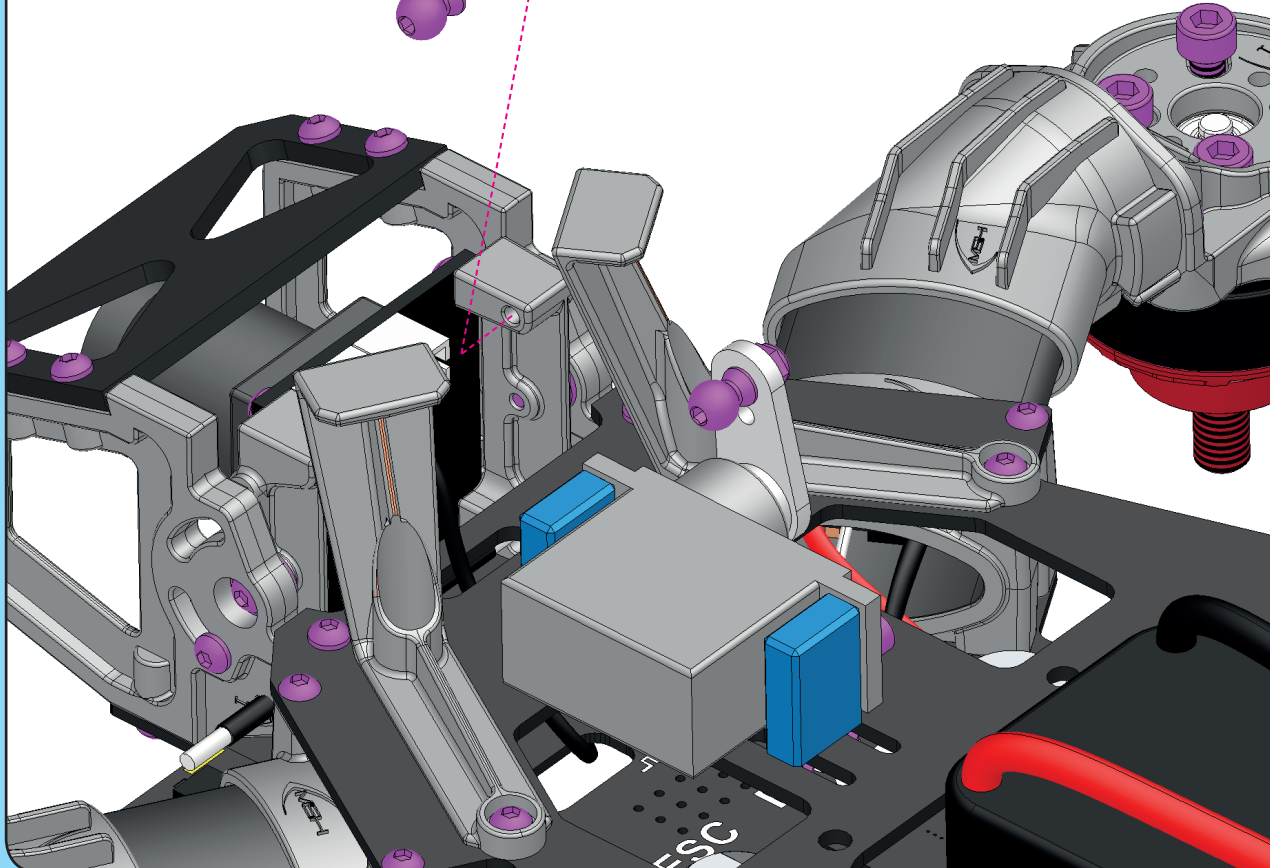
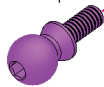

MSHeli s.r.l.
Uboldo (VA)
ITALY

